

REG. A/D & MAIL
JKWC (TPP)/PLNG/ENV/21/
Date: 21.05.2024

The Director,
Ministry of Environment, Forest & Climate Change (Integrated Regional Office),
A-209 & 218, "ARANYA BHAWAN", Jhalana Institutional Area, Jaipur-302004
Email: iro.jaipur-mefcc@gov.in

Subject : Half Yearly Compliance Report of Environmental Clearance conditions of 7.5 MW TPP of M/s JK White Cement Works (Unit of J K Cement Ltd.), situated at P.O. Gotan, Tehsil - Merta, Distt. Nagaur, Rajasthan for the Period from 1st Oct 2023 to 31st Mar, 2024.

Ref. : Letter No. J-13012/187/07-IA-II(T) dated 31.12.2007

Dear Sir,

As above subjected matter, submitting herewith the point - wise compliance report of the conditions of environment clearance issued by the board vides letter from MoEF, New Delhi mentioned as reference.

Project Code : Raj - 32/581/08
Name of the Project : 7.5 MW Captive Power Plant
Clearance Letter No. : J-13012/187/07-IA-II(T) dated 31.12.2007.
Period of Compliance : From 1st Oct-2023 to 31st Mar-2024.

COMPLIANCE CONDITIONS:

Sr.	Conditions	Compliance Status
1.	No additional land shall be acquired for any activity relating to the proposed project.	TPP Plant is installed at premises of M/s JK White Cement Works.
2.	Sulphur contents in coal and lignite to be used as fuel for the project shall not exceed 0.7 % and 1.0 % respectively. In the event of the Sulphur content exceeding the prescribed limits, lime treatment shall be given to control SO2 emission by at least 90%.	Coal, lignite has been used for power generation having Sulphur content below 0.7% & 1% respectively. If the Sulphur contents are found more then prescribed limit, lime treatment will be given (Limestone/Dolomite feed with coal and achieved emission within limit).
3.	The height of the stack shall be as per the standards prescribed under the Environment (Protection) Act in this regards or 72m, whichever is more with continuous online monitoring system. The exit velocity of the flue shall not be less than 18 m/sec.	Stack of height is 72 meters provided as per board direction. Online Continuous Emission monitoring system is installed at site as per norms. In this compliance period plant was under shutdown.

Corporate Office

📍 Prism Tower, 5th Floor, Ninaniya Estate,
Gwal Pahari, Gurugram - 122102, Haryana
☎ +0124-6919000
📧 admin.prismt@jkcement.com
🌐 www.jkcement.com

**JK SUPER
CEMENT**
BUILD SAFE

Manufacturing Units at :
Nimbahera, Mangrol, Gotan (Rajasthan) | Muddapur (Karnataka)
Jharli (Haryana) | Katni, Panna (M.P.) | Aligarh, Hamirpur (U.P.)
Balasinor (Gujarat) | Fujairah

**JKcement
WallMaxX**
White Cement Based Putty

Registered Office : 📍 Kamla Tower, Kanpur-208001, U.P., India. ☎ +91-512-2371478 to 85 📞 91-512-2399854 🌐 www.jkcement.com

Jodhpur Office : 📍 182, Gopi Krishna Vihar, Near Guru Ka Talab, Near Pratap Nagar, Jodhpur-342001. ☎ +0291-2432021, 2433072



4.	High efficiency electrostatic precipitators (ESPs) shall be installed to limit particulate emission to 100 mg/Nm ³ .	Three stage ESP has been installed. OCEMS installed at site which online are connected with RSPCB & CPCB servers. we are achieving <30 mg/Nm ³ particulate emission
5.	Dust extraction and suppression system and water sprinklers shall be provided for controlling fugitive dust during transportation, in coal /lignite storage & handling area and other vulnerable areas of the plant.	We have already taken care for controlling the fugitive dust emission by adopting the better housekeeping, concreting the movement areas and development of Green belt. Dust collector has been installed at coal crusher & Transfer Tower No. 1 & at Bunker top. Water sprinkle system has been provided at Grizzly Hopper for controlling of dust.
6.	Water requirement shall be met from the saving of water to be achieved with the replacement of DG sets and from STP. No additional water shall be extracted for the project.	Total water requirement of the project is 172 KL/D, out of which 61 KL has been met from STP treated water & 111 KL/D met as substitute of phased out DG set which is presently not in running due to TPP. Above was projected but actual consumption with ACC is very low.
7.	Air cooled condenser shall be provided	Air Cooled Condenser is provided
8.	The treated effluent shall be re-circulated and reused within the plant area. There shall be no waste discharge outside the plant boundary.	Wastewater discharge from various processes from thermal power plant. After proper neutralization/treatment it is used for dust suppression/ coal yard. There is no water discharge outside the plant boundary and maintained ZLD.
9.	Rainwater harvesting shall be practiced. A detailed scheme for rain water harvesting to recharge the ground water aquifer shall be prepared in consultation with Central Ground Water Authority /State Ground Water Board and a copy of the same shall be submitted within three months to this Ministry.	We have maintained rainwater harvesting recharge structures in good condition for ground water recharge according to CGWA guidelines. All details has provided with pervious compliance reports.
10.	Leq of Noise level shall be limited to 75 dB (A) and regular maintenance of equipment's should be undertaken. For people working in high noise areas, personal protection devices should be provided.	Regular noise monitoring shall be ensured around plant boundary within stipulated norms. Recognized approved lab Report of Noise Monitoring As well as self are attached as Annexure-1.
11.	Dry ash collection system shall be provided. 100 % ash utilization shall be ensured from the day one of the commissioning of the plant.	Arrangement for collection of dry ash has been provided. 100 % flyash/Cinder is utilized in our own and sister cement plants as well as for sale to local vendors. Annual audit was conducted by accredited personnel/Institution MNIT, Jaipur.
12.	A green belt shall be developed around the plant boundary with tree density of at least 1500 per ha covering 1/3rd of the project area	Green belt developed around the TPP boundary side & nearby area also maintained more then 1/3rd project area. Different type of tree saplings like as Neem, Desi Ashok, Pendular Ashok, Arjun etc. has been planted. Plantation Layout Plan is attached as Annexure-2
13.	First aid and sanitation arrangements shall be made for the drivers and other contract	Sanitation facilities for operators/workers have been provided.



	workers during construction.	
14.	Regular monitoring of the ambient air quality shall be carried out in and around the power plant and records maintained. The location of monitoring stations and frequency of monitoring shall be decided in consultation with the State Pollution Control Board. Periodic reports shall be submitted to the Regional Office of this Ministry at Lucknow.	The TPP is in the same premises of J K White Cement Works hence four manual AAQM stations are monitored regularly in consultation with Regional Office for the parameters of SPM/PM10/PM2.5, SO2, NOx & CO and results are well within the prescribed norms. Four number CAAQMS Station installed as per guidelines and connected to RSPCB and CPCB servers for online monitoring. Most of time Plant is under shutdown due to power management. Ambient Air Quality Monitoring Reports from NABL approved laboratory are attached as Annexure -1
15.	The project proponent shall advertise in at least two local newspaper widely circulated in the region around the project, one of which shall be in the vernacular language of the locality concerned within seven days of issue of this letter, informing that the project has been accorded environmental clearance and copies of clearance letter are available with the State Pollution Control Board/Committee and may also seen at Website of the Ministry of Environment & Forest at http://enfor.nic.in	Grant of Environmental Clearance has advertised in Rajasthan Patrika & Dainik Bhasker on dated 03.01.2008. copy already provided to your good office.
16.	A separate environment management cell with qualified staff shall be set up for implementation of the stipulated environmental safeguards.	Environment Dept. has been setup for environmental management. Unit Head to look after about the total control of pollution, monitoring & maintenance of pollution control devices with the help of Site Manager along with Environment Dept. Officers, Engineer (Chemical) & trained team.
17.	Half yearly report on the status of implementation of the stipulated conditions and environmental safeguard shall be submitted to this Ministry, the Regional Office, and the CPCB / SPCB.	Complete half yearly report is submitted to all concerned departments within time frame as directed.
18.	Regional Office of the Ministry of Environmental & Forests located at Lucknow will monitor the implementation of the stipulated conditions. A complete set of documents submitted to this ministry shall be forwarded to the Regional Office for their use during monitoring.	The complete set of documents is forwarded to concerned departments.
19.	Separate funds shall be allocated for implementation of environmental protection measures along with item-wise break-up. These costs shall be include as part of the project cost. The funds earmarked for the environment protection measures shall not be diverted for other purpose and year-wise expenditure shall be reported to the Ministry.	The total cost of project is 43 crore apx. out of which Rs. 339 Lacs invested for Env. Protection measures & Rs. 29 Lacs kept for recurring expenditure on environmental protection (During plant erection & commissioning).



20.	Full cooperation shall be extends to the Scientist/Officers from the Ministry / Regional Office of the Ministry at Lucknow / the CPCB / the SPCB who would be monitoring the compliance of environmental status.	Agreed
-----	--	--------

Remark: Plant is under shutdown from Jul-23 to till date. The information has already been communicated to the board.

Occupational health surveillance report (Medical Checkup) attached. Annexure-3.

We hope you will find the document in order.

Thanking you,

Yours faithfully

For J K White Cement Works (Unit of J K Cement Ltd.)



Dr. Rajeev Kumar Bagariya
(Environment Head)
Authorized Signatory

CC To:

Reg. A/d: Member Secretary,
Rajasthan State Pollution Control Board
4, Institutional Area, Jhalana Doongari, Jaipur (Raj.) - 302 004

Reg. A/d: Regional Officer (Regional Office),
Rajasthan State Pollution Control Board,
First Floor, Sehkari Bhoomi Vikas Bank Ltd., Nagaur- 341001

TEST REPORT

ANNEXURE: 1



Sample Number: VTL/AA/23-26 Report No.: VTL/A/2312250023-26/A
 Name & Address of the Party: M/s JK White Cement Works (Unit of JK Cement Ltd.) Vill. & Po.- Gotan, Dist.-Nagaur, Rajasthan Format No.: 7.8 F 02
 Party Reference No.: Nil.
 Report Date: 28/12/2023
 Sample Description: Ambient Air Quality Monitoring Period of Analysis: 25-28/12/2023
 Receipt Date: 25/12/2023

General Information:-

Sample collected by : VTL Team
 Instrument Calibration Status : Calibrated
 Meteorological condition during monitoring : Clear sky
 Date of Sampling : 19/12/2023 to 20/12/2023
 Ambient Temperature (°C) : Min. 10°C, Max. 25 °C
 Surrounding Activity : Human , Vehicular & Plant Activities
 Scope of Monitoring : Regulatory Requirement
 Sampling & Analysis Protocol : IS-5182 & CPCB Guidelines
 Sampling Duration : 24 hrs.
 Parameter Required : As Per Work Order

Sr.	Parameter	Protocol	Location & Lat. Long				Unit	NAAQS 2009
			132 KVSS	Rest Shelter /Doolomite Ramp	EDP Club Building	CS-11		
			73°44'46"E 26°38'50"N	73°44'32"E 26°38'43"N	73°44'33"E 26°38'30"N	73°44'46"E 26°38'28"N		
1.	Particulate Matter (PM10)	IS: 5182 (P-23), 2006, RA 2017	62.41	66.74	59.45	63.58	µg/m ³	100
2.	Particulate Matter (PM2.5)	IS 5182 (P-24) -2019	31.26	36.35	39.71	32.65	µg/m ³	60
3.	Nitrogen Dioxide (NO2)	IS: 5182 (P-6), 2006 RA 2018	9.12	11.32	9.87	10.68	µg/m ³	80
4.	Sulphur Dioxide (SO2)	IS: 5182 (P-2), 2001, RA 2018	15.42	18.71	14.82	16.74	µg/m ³	80
5.	Benzene (as C6H6)	IS: 5182 (P-11)-2006, RA.2017	*BLQ(**LOQ1.0)	*BLQ(**LOQ1.0)	*BLQ(**LOQ1.0)	*BLQ(**LOQ1.0)	µg/m ³	5
6.	Ammonia (as NH3)	3 rd Ed. 1988, Method No. 401	6.98	8.29	6.84	7.65	µg/m ³	400
7.	Ozone (as O3)	IS:5182 (P-9):1974, RA.2019	10.32	12.04	9.53	11.85	µg/m ³	180
8.	Lead (as pb)	IS:5182 (P-22):2004, RA.2019	*BLQ(**LOQ0.02)	*BLQ(**LOQ0.02)	*BLQ(**LOQ0.02)	*BLQ(**LOQ0.02)	µg/m ³	1
9.	Arsenic (as As)	3 rd Ed. 1988, Method No. 302	*BLQ(**LOQ0.15)	*BLQ(**LOQ0.15)	*BLQ(**LOQ0.15)	*BLQ(**LOQ0.15)	ng/m ³	6
10.	Nickel (as Ni)	USEPA Compendium 10-3.2, 1999	*BLQ(**LOQ5.0)	*BLQ(**LOQ5.0)	*BLQ(**LOQ5.0)	*BLQ(**LOQ5.0)	ng/m ³	20
11.	Benzo (a) Pyrene	IS:5182 (P-12):2004, RA.2019	*BLQ(**LOQ0.2)	*BLQ(**LOQ0.2)	*BLQ(**LOQ0.2)	*BLQ(**LOQ0.2)	ng/m ³	1

-----End of the Report-----

Checked By



RK Yadav
Lab Incharge
Authorized Signatory

Approved & Certified EPA 1986 Recognised, ISO:9001 and OHSAS:45001 Certified

Vibrant Techno Lab Pvt. Ltd.

SC-40, 3rd Floor, Narayan Vihar S, Ajmer Road, Jaipur Raj. 302020

9929108691, 9810205356, 8005707098, 9549956601

0141-2954638

bd@vibranttechnolab.com

www.vibranttechnolab.com

TEST REPORT



Sample Number: VTL/AA/23-26 Report No.: VTL/A/2312250023-26/B
 Name & Address of the Party: M/s JK White Cement Works (Unit of JK Cement Ltd.) Vill. & Po.- Gotan, Dist.-Nagaur, Rajasthan Format No.: 7.8 F 02
 Party Reference No.: NIL
 Report Date: 28/12/2023
 Sample Description: Ambient Air Quality Monitoring Period of Analysis: 25-28/12/2023
 Receipt Date: 25/12/2023

General Information:-
 Sample collected by : VTL Team
 Instrument Calibration Status : Calibrated
 Meteorological condition during monitoring : Clear sky
 Date of Sampling : 19/12/2023 to 20/12/2023
 Ambient Temperature (°C) : Min. 10°C, Max. 25 °C
 Surrounding Activity : Human , Vehicular & Plant Activities
 Scope of Monitoring : Regulatory Requirement
 Sampling & Analysis Protocol : IS-5182 & CPCB Guidelines
 Sampling Duration : 24 hrs.
 Parameter Required : As Per Work Order

Sr.	Parameter	Protocol	Location & Lat. Long				Unit	NAAQS 2009
			132 KVSS	Rest Shelter /Doolomite Ramp	EDP Club Building	CS-11		
			73°44'46"E 26°38'50"N	73°44'32"E 26°38'43"N	73°44'33"E 26°38'30"N	73°44'46"E 26°38'28"N		
1.	Carbon Monoxide (as CO)	Lab SOP no. VTL/STP/02:2022, STP-08	0.52	0.59	0.50	0.53	mg/m ³	4

-----End of the Report-----

VIBRANT
 "Experience the unimaginable"

Checked By



RK Yadav
 Lab Incharge
 Authorized Signatory

Approved & Certified EPA 1986 Recognised, ISO:9001 and OHSAS:45001 Certified

Vibrant Techno Lab Pvt. Ltd.

SC-40, 3rd Floor, Narayan Vihar S, Ajmer Road, Jaipur Raj. 302020
 9929108691, 9810205356, 8005707098, 9549956601

0141-2954638
 bd@vibranttechnolab.com
 www.vibranttechnolab.com

TEST REPORT



TC-11227

Sample Number:	VTL/AN/23-26	Report No.:	VTL/N/2312250023-26/A
Name & Address of the Party:	M/s JK White Cement Works (Unit of JK Cement Ltd.) Vill. & Po.- Gotan, Dist.-Nagaur, Rajasthan	Format No.:	7.8 F 04
Sample Description:	Ambient Noise Level Monitoring	Party Reference No.:	NIL
Scope of Monitoring	Regulatory Requirement	Report Date:	28/12/2023
Protocol Used:	IS 9989	Receipt Date:	25/12/2023
Instrument Used:	SLM	Sampling Duration	2 [^] Hrs.
		Sample Collected by	VTL Team
		Instrument	
		Calibration Status	Calibrated

Ambient Noise Level Monitoring Results

General Information:-

Meteorological condition during monitoring	: Clear sky
Date of Monitoring	: 19/12/2023 to 20/12/2023
Time of Monitoring	: 06:00 AM to 06:00AM
Ambient Temperature (°C)	: Min. 10°C, Max. 25 °C
Surrounding Activity	: Human, Vehicular & Plant Activities
Parameter Required	: As per Work Order

Sr.	Test Parameter	Protocol	Location & Latlong							
			132 KVSS		Rest Shelter /Doolomite Ramp		EDP Club Building		CS-11	
			73°44'46"E 26°38'50"N	73°44'32"E 26°38'43"N	73°44'33"E 26°38'30"N	73°44'46"E 26°38'28"N	Day Time	Night Time	Day Time	Night Time
1.	Leq, dB(A)	IS:9989-1981, RA 2020	Day Time	Night Time	Day Time	Night Time	Day Time	Night Time	Day Time	Night Time
			59.3	49.1	63.8	44.6	64.5	45.1	58.1	48.3

Category of Zones	Leq in dB (A)	
	Day	Night
Industrial	75	70
Commercial	65	55
Residential	55	45
Silence Zone	50	40

1. Day Time is from 6.00 AM to 10.00 PM.
 2. Night Time is reckoned between 10.00 PM to 6.00 AM.
 3. Silence Zone is defined as an area up to 100 m around premises of Hospitals, Educational and Courts. Use of vehicle horn, Loudspeakers and bursting of crackers is banned in these zones.
 Note: Mixed categories of areas be declared as one of the four above mentioned categories by the competent Authority and the corresponding standards shall apply

-----End of the Report-----

Checked By



RK Yadav
 Lab Incharge
 Authorized Signatory

Terms & conditions PTO

Approved & Certified EPA 1986 Recognised, ISO:9001 and OHSAS:45001 Certified

Vibrant Techno Lab Pvt. Ltd.

SC-40, 3rd Floor, Narayan Vihar S, Ajmer Road, Jaipur Raj. 302020
 9929108691, 9810205356, 8005707098, 9549956601

☎ 0141-2954638
 ✉ bd@vibranttechnolab.com
 🌐 www.vibranttechnolab.com

TEST REPORT



Sample Number : VTLWWW/01

M/S JK White Cement Works
(Unit of JK Cement Ltd.) Vill. & Po. Gotan, Dist. -
Nagaur, Rajasthan

Name & Address of the Party :

Sample Description : Waste Water
Sampling Location : STP Outlet (STP Treated Water) 500 KLD STP
Sample Collected By : VTL Team, 73.748795 N & 26.638279E
Coordinates : --

ULR No. : TC1122723000000658F
Report No. : VTLWWW/2312250001/A
Format No : 7.8 F-01
Party Reference No : NIL
Report Date : 28/12/2023
Period of Analysis : 25/12/2023-28/12/2023
Receipt Date : 25/12/2023
Sampling Date : 22/12/2023
Parameter Required : As per work order

S.No.	Test Parameters	Test Method	Result	Unit	Limits
1	pH	IS: 3025 (P-11): 2022	7.73	-	5.5 to 9.0
2	Total Suspended Solids (TSS)	IS: 3025 (P-17): 2022	15.70	mg/l	100
3	Temperature	IS: 3025 (P-9): 1984, RA 2017	1.6	°C	Shall not exceed 5°C above the receiving water temperature
4	Oil & Grease	IS:3025 (P-39): 2021	*BLQ(**LOQ-4.0)	mg/l	10
5	Ammonical Nitrogen (as NH ₃ -N)	IS: 3025 (P-34) : 1988, Sec.4 RA: 2022	6.2	mg/l	50
6	Total Kjeldahl Nitrogen (as NH ₃)	IS: 3025 (P-34): 1988, RA 2022 (Macro Kjeldahl Method)	8.64	mg/l	100
7	Biochemical Oxygen Demand (BOD) (3 days @ 27°C)	IS: 3025 (P-44): 1993, RA: 2019	19.0	mg/l	30
8	Chemical oxygen Demand (COD)	IS : 3025 (P-58) : 2006 RA: 2017	85.0	mg/l	250
9	Sulphide (as S)	IS: 3025 (P-29) :1986 Idometric, RA :2019	0.16	mg/l	2
10	Residual Free Chlorine	IS: 3025 (P-26):2021	0.28	mg/l	1.0

*BLQ-Below Limit OF Quantification, **LOQ- Limit Of Detection

End of Report

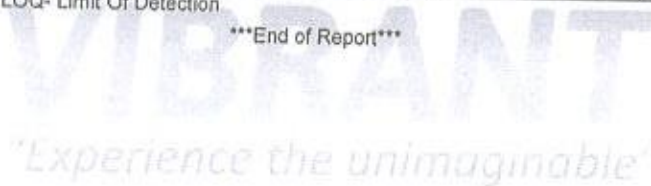

Checked by



RK Yadav
Lab Incharge
Authorized Signatory



Page No. 1/1

Term & conditions PTO

Approved & Certified EPA 1986 Recognised, ISO:9001 and OHSAS:45001 Certified

Vibrant Techno Lab Pvt. Ltd.

SC-40, 3rd Floor, Narayan Vihar S, Ajmer Road, Jaipur Raj. 302020
9929108691, 9810205356, 8005707098, 9549956601

0141-2954638
bd@vibranttechnolab.com
www.vibranttechnolab.com

TEST REPORT



Sample Number : VTL/WW/01

M/S JK White Cement Works
(Unit of JK Cement Ltd.) Vill. & Po. Gotan, Dist. -
Nagaur, Rajasthan

Name & Address of the Party :

Sample Description : Waste Water
Sampling Location : STP Outlet (STP Treated Water) 500 KLD STP
Sample Collected By : VTL Team, 73.748795 N & 26.638279E
Coordinates : --

Report No. : VTL/WW/2312250001/B
Format No : 7.8 F-01
Party Reference No : NIL
Report Date : 28/12/2023
Period of Analysis : 25/12/2023-28/12/2023
Receipt Date : 25/12/2023
Sampling Date : 22/12/2023
Parameter Required : As per work order

S.No.	Test Parameters	Test Method	Result	Unit	Limits
1	Chloride (as Cl)	IS: 3025 (P-32): 1988, RA. 2019	870.21	mg/l	--
2	Fecal Coliform	IS 1622, 2009	Absent		---

*BLQ-Below Limit OF Quantification, **LOQ- Limit Of Detection

End of Report



Checked by



RK Yadav
Lab Incharge
Authorized Signatory



TEST REPORT



Sample Number: VTL/AA/23-26 **Report No.:** VTL/A/2403210023-26/A
Name & Address of the Party: M/s JK White Cement Works (Unit of JK Cement Ltd.) Vill. & Po.- Gotan, Dist.-Nagaur, Rajasthan **Format No.:** 7.8 F 02
Party Reference No.: NIL
Report Date: 24/03/2024
Sample Description: Ambient Air Quality Monitoring **Period of Analysis:** 21-24/03/2024
Receipt Date: 21/03/2024

General Information:-
Sample collected by: : VTL Team
Instrument Calibration Status: : Calibrated
Meteorological condition during monitoring: : Clear sky
Date of Sampling: : 15/03/2024 to 16/03/2024
Ambient Temperature (°C): : Min. 15°C, Max. 32 °C
Surrounding Activity: : Human, Vehicular & Plant Activities
Scope of Monitoring: : Regulatory Requirement
Sampling & Analysis Protocol: : IS-5182 & CPCB Guidelines
Sampling Duration: : 24 hrs.
Parameter Required: : As Per Work Order

Sr.	Parameter	Protocol	Location & Lat. Long				Unit	NAAQS 2009
			132 KVSS	Rest Shelter /Doolomite Ramp	EDP Club Building	CS-11		
			73°44'46"E 26°38'50"N	73°44'32"E 26°38'49"N	73°44'33"E 26°38'30"N	73°44'46"E 26°38'28"N		
1.	Particulate Matter (PM10)	IS: 5182 (P-23), 2006, RA 2017	61.54	64.43	56.21	60.37	µg/m³	100
2.	Particulate Matter (PM2.5)	IS 5182 (P-24) -2019	29.11	34.25	38.04	30.42	µg/m³	60
3.	Sulphur Dioxide (SO2)	IS: 5182 (P-2), 2001 RA 2018	8.14	10.55	8.47	09.88	µg/m³	80
4.	Nitrogen Dioxide (NO2)	IS: 5182 (P-6), 2006 RA 2018	13.69	16.24	13.17	14.54	µg/m³	80
5.	Benzene (as C6H6)	IS: 5182 (P-11)-2006, RA.2017	*BLQ(**LOQ1.0)	*BLQ(**LOQ1.0)	*BLQ(**LOQ1.0)	*BLQ(**LOQ1.0)	µg/m³	5
6.	Ammonia (as NH3)	3rd Ed. 1988, Method No. 401	5.85	7.45	5.23	6.61	µg/m³	400
7.	Ozone (as O3)	IS:5182 (P-9):1974, RA.2019	09.48	11.27	8.12	10.53	µg/m³	180
8.	Lead (as pb)	IS:5182 (P-22):2004, RA.2019	*BLQ(**LOQ0.02)	*BLQ(**LOQ0.02)	*BLQ(**LOQ0.02)	*BLQ(**LOQ0.02)	µg/m³	1
9.	Arsenic (as As)	3rd Ed. 1988, Method No. 302	*BLQ(**LOQ0.15)	*BLQ(**LOQ0.15)	*BLQ(**LOQ0.15)	*BLQ(**LOQ0.15)	ng/m³	6
10.	Nickel (as Ni)	USEPA Compendium 10-3.2, 1999	*BLQ(**LOQ5.0)	*BLQ(**LOQ5.0)	*BLQ(**LOQ5.0)	*BLQ(**LOQ5.0)	ng/m³	20
11.	Benzo (a) Pyrene	IS:5182 (P-12):2004, RA.2019	*BLQ(**LOQ0.2)	*BLQ(**LOQ0.2)	*BLQ(**LOQ0.2)	*BLQ(**LOQ0.2)	ng/m³	1

Checked By:
 Approved & Certified:
 EPA 1986 Recognised, ISO:9001 and OHSAS:45001 Certified

RK Yadav
 Lab Incharge
 Authorized Signatory



TEST REPORT

Sample Number: VTL/AA/23-26
Name & Address of the Party: M/s JK White Cement Works (Unit of JK Cement Ltd.) Vill. & Po.- Gotan, Dist.-Nagaur, Rajasthan
Report No.: VTL/A/2403210023-26/B
Format No.: 7.8 F 02
Party Reference No.: NIL
Report Date: 24/03/2024
Sample Description: Ambient Air Quality Monitoring
Period of Analysis: 21-24/03/2024
Receipt Date: 21/03/2024

General Information:-
Sample collected by : VTL Team
Instrument Calibration Status : Calibrated
Meteorological condition during monitoring : Clear sky
Date of Sampling : 15/03/2024 to 16/03/2024
Ambient Temperature (°C) : Min. 15°C, Max. 32 °C
Surrounding Activity : Human, Vehicular & Plant Activities
Scope of Monitoring : Regulatory Requirement
Sampling & Analysis Protocol : IS-5182 & CPCB Guidelines
Sampling Duration : 24 hrs.
Parameter Required : As Per Work Order

Sr.	Parameter	Protocol	Location & Lat. Long				Unit	NAAQS 2009
			132 KVSS	Rest Shelter /Doolomite Ramp	EDP Club Building	CS-11		
			73°44'46"E 26°38'50"N	73°44'32"E 26°38'43"N	73°44'33"E 26°38'30"N	73°44'46"E 26°38'28"N		
1.	Carbon Monoxide (as CO)	Lab SOP no. VTL/STP/02:2022, STP-0B	0.49	0.56	0.48	0.51	mg/m ³	4

-----End of the Report-----

VIBRANT
"Experience the unimaginable"

Checked By



RK Yadav
Lab Incharge
Authorized Signatory

Approved & Certified EPA 1986 Recognised, ISO:9001 and OHSAS:45001 Certified

Vibrant Techno Lab Pvt. Ltd.

SC-40, 3rd Floor, Narayan Vihar S, Ajmer Road, Jaipur Raj. 302020
9929108691, 9810205356, 8005707098, 9549956601

0141-2954638
bd@vibranttechnolab.com
www.vibranttechnolab.com



TEST REPORT



Sample Number:	VTL/AN/23-26	Report No.:	VTL/N/2403210023-26/A
Name & Address of the Party:	M/s JK White Cement Works (Unit of JK Cement Ltd.)VIII. & Po.- Gotan, Dist.-Nagaur, Rajasthan	Format No.:	7.8 F 04
Sample Description:	Ambient Noise Level Monitoring	Party Reference No.:	NIL
Scope of Monitoring:	Regulatory Requirement	Report Date:	24/03/2024
Protocol Used:	IS 9989	Receipt Date:	21/03/2024
Instrument Used:	SLM	Sampling Duration:	24 Hrs.
		Sample Collected by:	VTL Team
		Instrument:	
		Calibration Status:	Calibrated

Ambient Noise Level Monitoring Results

General Information:-

Meteorological condition during monitoring : Clear sky
 Date of Monitoring : 15/03/2024 to 16/03/2024
 Time of Monitoring : 06:00 AM to 06:00AM
 Ambient Temperature (°C) : Min. 15°C, Max. 32 °C
 Surrounding Activity : Human, Vehicular & Plant Activities
 Parameter Required : As per Work Order

Sr.	Test Parameter	Protocol	Location & Latlong							
			132 KVSS		Rest Shelter /Doolomlte Ramp		EDP Club Building		CS-11	
			73°44'46"E 26°38'50"N		73°44'32"E 26°38'43"N		73°44'33"E 26°38'30"N		73°44'46"E 26°38'28"N	
61.	Leq, dB(A)	IS:9989-1981, RA 2020	Day Time	Night Time	Day Time	Night Time	Day Time	Night Time	Day Time	Night Time
			57.1	48.3	61.4	43.5	62.2	42.6	56.7	47.9

Category of Zones	Leq in dB (A)	
	Day	Night
Industrial	75	70
Commercial	65	55
Residential	55	45
Silence Zone	50	40

- Day Time is from 6.00 AM to 10.00 PM.
 - Night Time is reckoned between 10.00 PM to 6.00 AM.
 - Silence Zone is defined as an area up to 100 m around premises of Hospitals, Educational and Courts. Use of vehicle horn, Loudspeakers and bursting of crackers is banned in these zones.
- Note: Mixed categories of areas be declared as one of the four above mentioned categories by the competent Authority and the corresponding standards shall apply

-----End of the Report-----

Checked By



RK Yadav
Lab Incharge
Authorized Signatory

Terms & conditions PTO

Approved & Certified EPA 1986 Recognised, ISO:9001 and OHSAS:45001 Certified

Vibrant Techno Lab Pvt. Ltd.

SC-40, 3rd Floor, Narayan Vihar S, Ajmer Road, Jaipur Raj. 302020
 9929108691, 9810205356, 8005707098, 9549956601

0141-2954638
 bd@vibranttechnolab.com
 www.vibranttechnolab.com

Ambient Noise Level Measurement Record (in dB (A))
at Thermal Power Plant Site

Date: 28/10/2023

Time: 11:02

Day/ Night:

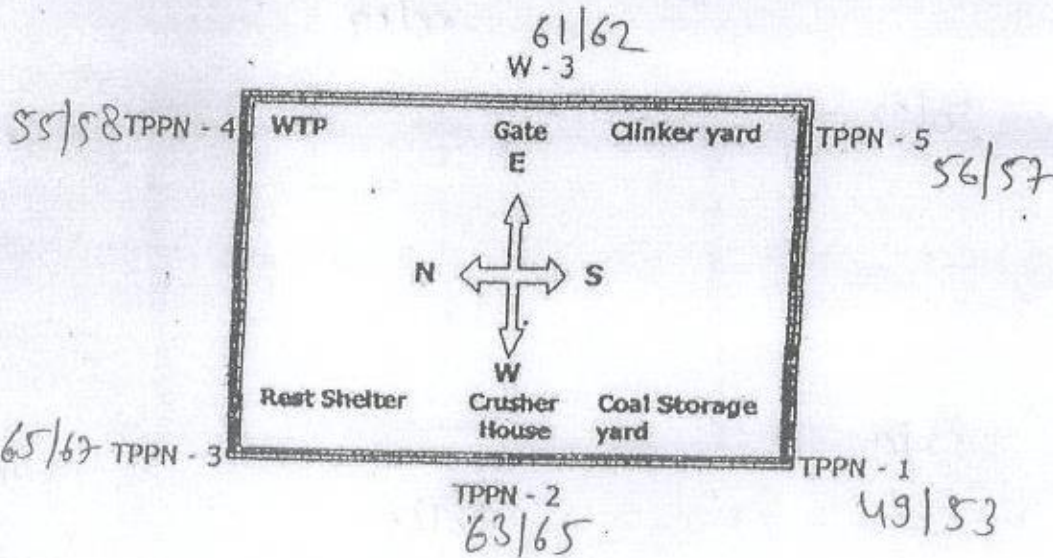

Crusher : Operating / Not Operating
 Boiler : Operating / Not Operating
 Air Cooled Condenser : Operating / Not Operating
 WTP : Operating / Not Operating
 Air Compressor : Operating / Not Operating

Leq. 57.22

REMARKS IF ANY:

Measured by: [Signature]

[Signature]
Dr. R.K. Bagariya

**Ambient Noise Level Measurement Record (in dB (A))
at Thermal Power Plant Site**

Date: 28/10/2023

Time:

Day/ Night:

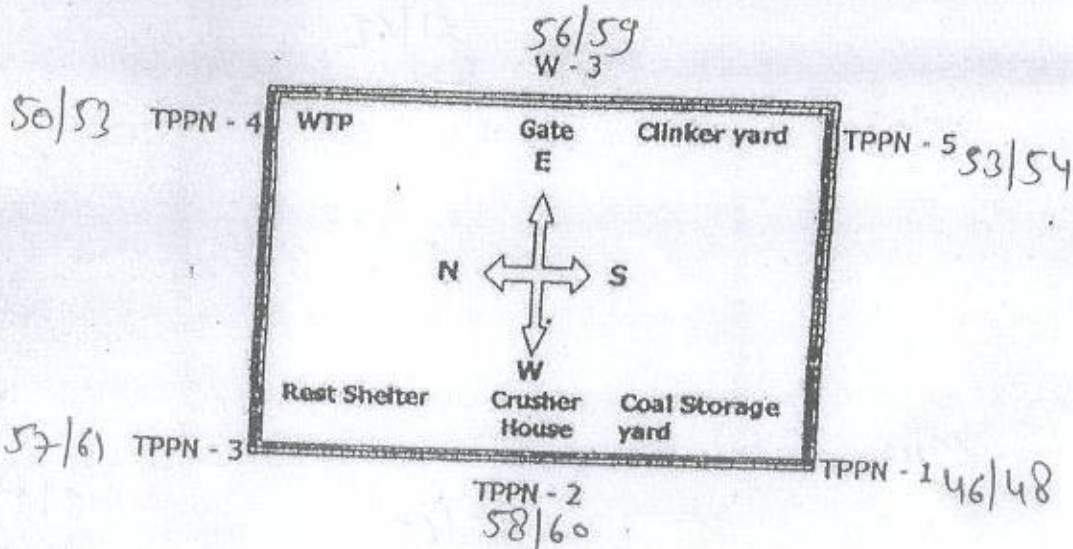

- Crusher : Operating / Not Operating
- Boller : Operating / Not Operating
- Air Cooled Condenser : Operating / Not Operating
- WTP : Operating / Not Operating
- Air Compressor : Operating / Not Operating

Leq - 53.4

REMARKS IF ANY:

Measured by: [Signature]

[Signature]
Dr. R. K. Bagariya

Ambient Noise Level Measurement Record (in dB (A))
at Thermal Power Plant Site

Date: 25/11/2023

Time: 11:40

Day/ Night:

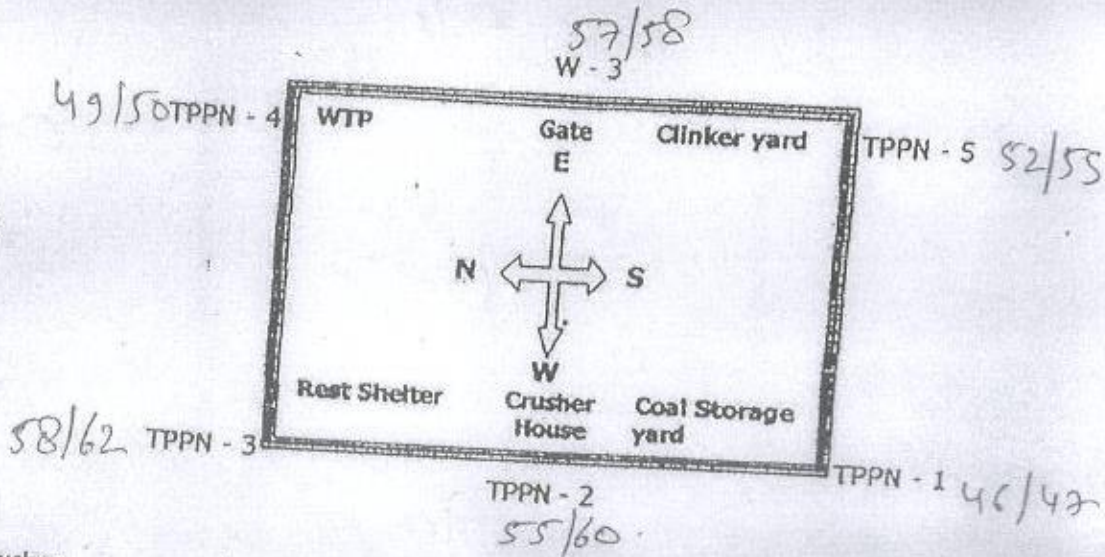

Crusher	: Operating / Not Operating
Boller	: Operating / Not Operating
Air Cooled Condenser	: Operating / Not Operating
WTP	: Operating / Not Operating
Air Compressor	: Operating / Not Operating

Leq. 52.9

REMARKS IF ANY:

Measured by: [Signature]

[Signature]
Dr. R.K. Bagariya

Ambient Noise Level Measurement Record (in dB (A))
at Thermal Power Plant Site

Date: 30/12/2023

Time: 11:30

Day/ Night:

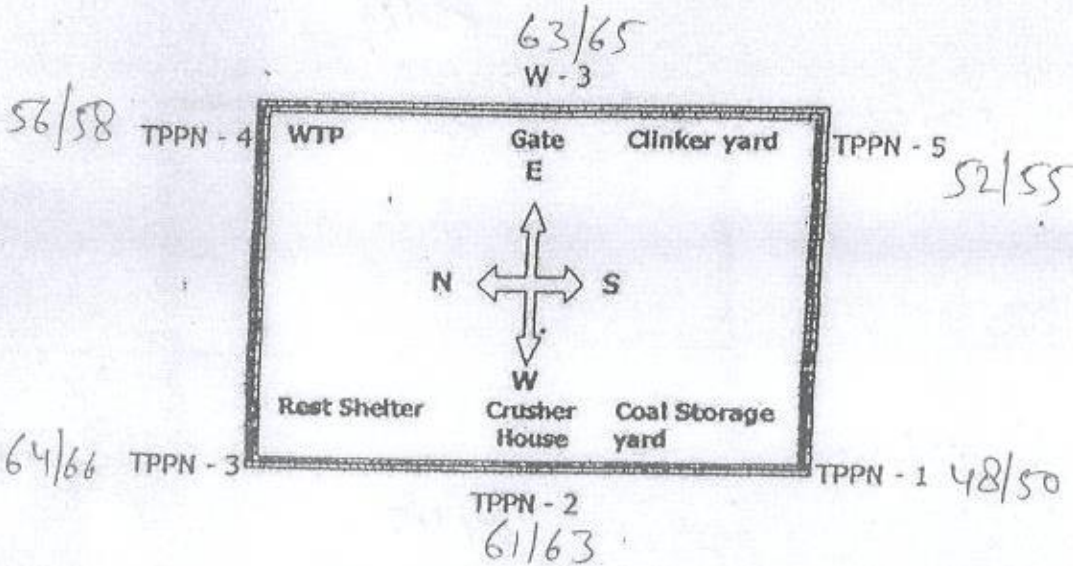

Crusher : Operating / Not Operating

Boiler : Operating / Not Operating

Air Cooled Condenser : Operating / Not Operating

WTP : Operating / Not Operating

Air Compressor : Operating / Not Operating

Log. 54.81

REMARKS IF ANY:

 Measured by:



 Dr. R.K. Bagariya

**Ambient Noise Level Measurement Record (in dB (A))
at Thermal Power Plant Site**

Date: 23/12/2023

Time: 10.50

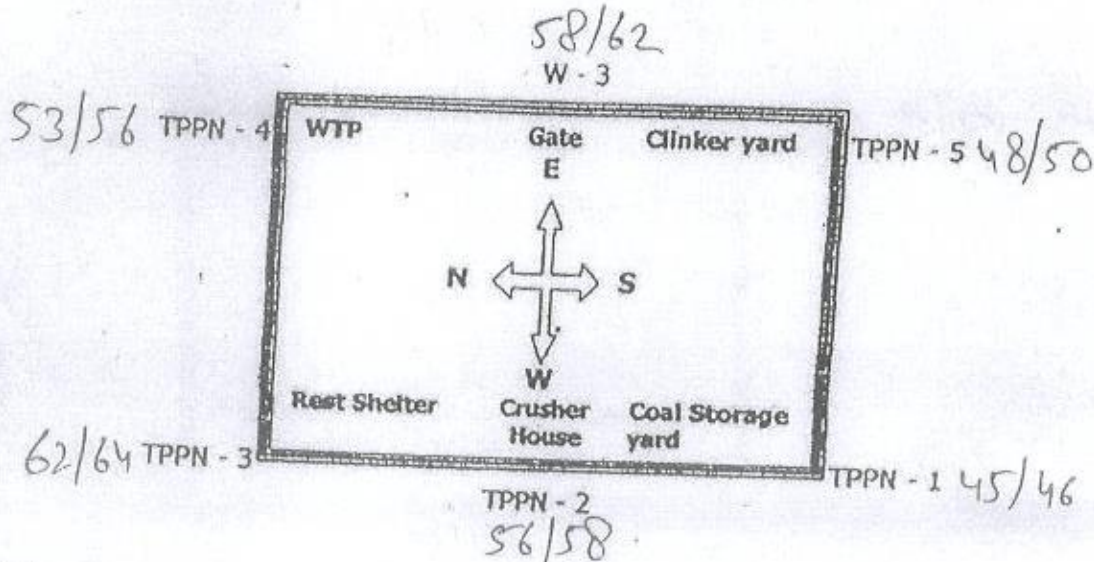
Day/ Night:



- Crusher : Operating / Not Operating
- Boiler : Operating / Not Operating
- Air Cooled Condenser : Operating / Not Operating
- WTP : Operating / Not Operating
- Air Compressor : Operating / Not Operating

Leq - 54.17

REMARKS IF ANY:

Measured by: [Signature]

Dr. R.K. Bagariya

Ambient Noise Level Measurement Record (in dB (A))
at Thermal Power Plant Site

Date: 28/01/2024

Time: 10.10

Day/ Night:

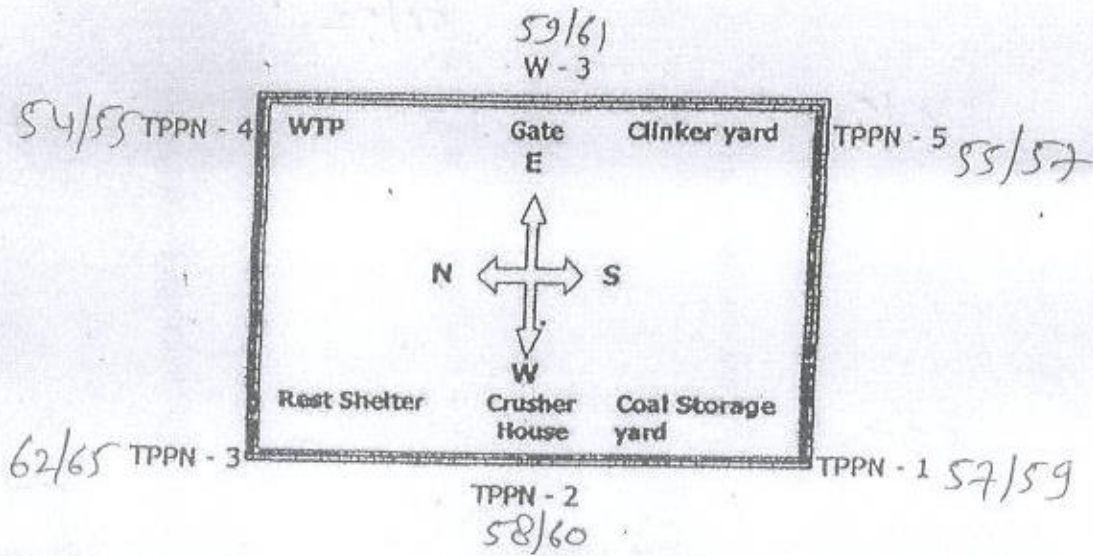

- Crusher : Operating / ~~Not Operating~~
- Boller : Operating / ~~Not Operating~~
- Air Cooled Condenser : Operating / ~~Not Operating~~
- WTP : Operating / ~~Not Operating~~
- Air Compressor : Operating / ~~Not Operating~~

Leq. 57.13

REMARKS IF ANY:

Measured by: Himanshu

Dr. R.K. Bagariya

**Ambient Noise Level Measurement Record (in dB (A))
at Thermal Power Plant Site**

Date: 28/02/2024

Time: 11.45

Day/ Night:

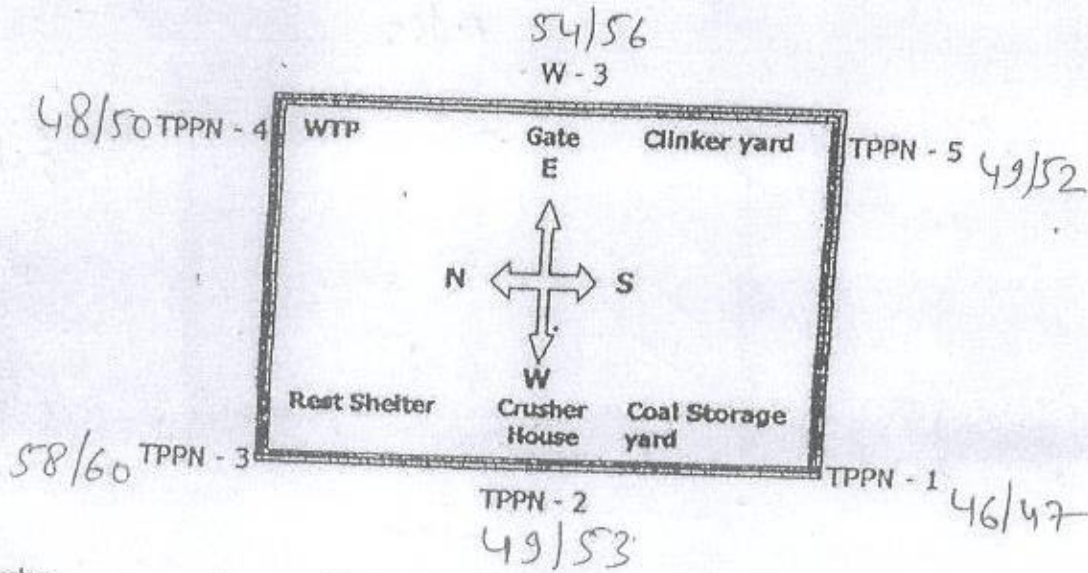

Crusher	: Operating / Not Operating
Boller	: Operating / Not Operating
Air Cooled Condenser	: Operating / Not Operating
WTP	: Operating / Not Operating
Air Compressor	: Operating / Not Operating

Leq. 50.8

REMARKS IF ANY:

Measured by: [Signature]

[Signature]
Dr. R.K. Begariya

**Ambient Noise Level Measurement Record (in dB (A))
at Thermal Power Plant Site**

Date: 23/03/2024

Time: 9.30

Day/ Night:

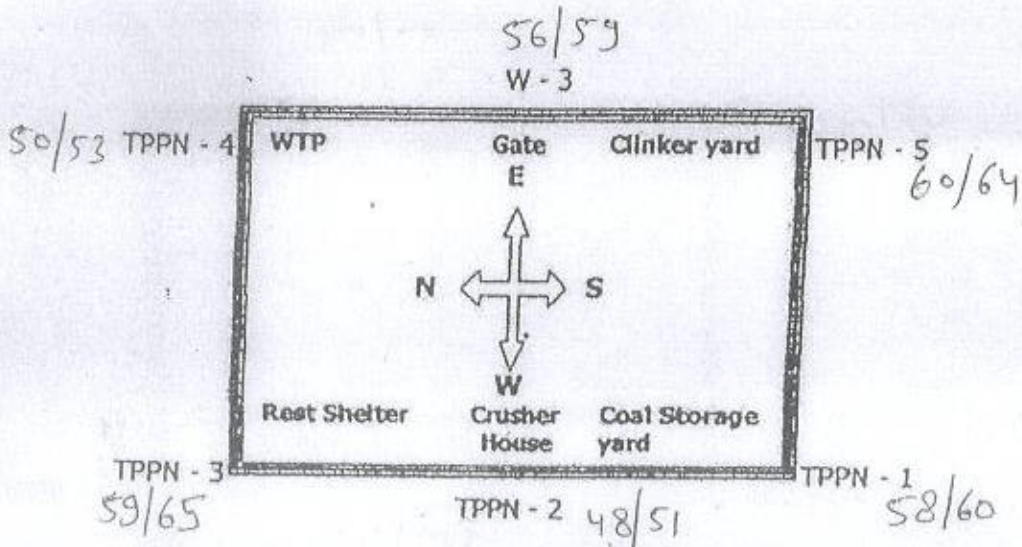

Crusher : Operating / Not Operating

Boiler : Operating / Not Operating

Air Cooled Condenser : Operating / Not Operating

WTP : Operating / Not Operating

Air Compressor : Operating / Not Operating

Leq. 55.31

REMARKS IF ANY:

Measured by: T. K. Bagariya

Dr. R. K. Bagariya

**Ambient Noise Level Measurement Record (in dB (A))
at Thermal Power Plant Site**

Date: 23/03/2024

Time: 11:20

Day/ Night:

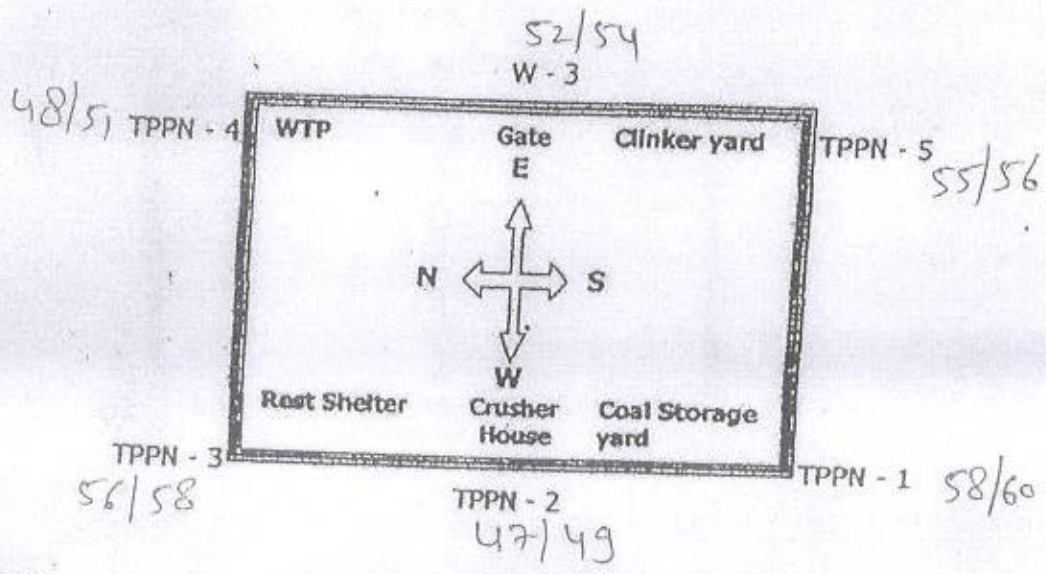

- Crusher : Operating / Not Operating
- Bolfer : Operating / Not Operating
- Air Cooled Condenser : Operating / Not Operating
- WTP : Operating / Not Operating
- Air Compressor : Operating / Not Operating

REMARKS IF ANY:

Measured by: [Signature]

[Signature]
Dr. R.K. Bagariya

ANNEXURE: 2



194	PETRO COKE COVERED SHED
142	TPP OFFICE
141	ASH SILO(TPP)
140	FUEL STORAGE YARD(TPP)
139	GREZZALY HOPPER(TPP)
138	CRUSHER HOUSE(TPP)
137	CONVEYOR(TPP)
136	CHIMNEY (TPP)
135	ID FAN(TPP)
134	ESP(TPP)
133	FD FAN(TPP)
132	PA FAN(TPP)
131	BUNKER(TPP)
130	BOILER(TPP)
129	TRANSFORMER YARD(TPP)
128	DEAERATOR CUM STORAGE TANK (TPP)
127	CONTROL ROOM(TPP)
126	TG HOUSE(TPP)
125	AUXILIARY TOWER (TPP)
124	AIR COOLED CONDENSOR (TPP)
123	DM STORAGE TANK (TPP)
122	WATER TREATMENT PLANT (TPP)
121	RAW WATER STORAGE TANK (TPP)
	S.NO. INDEX

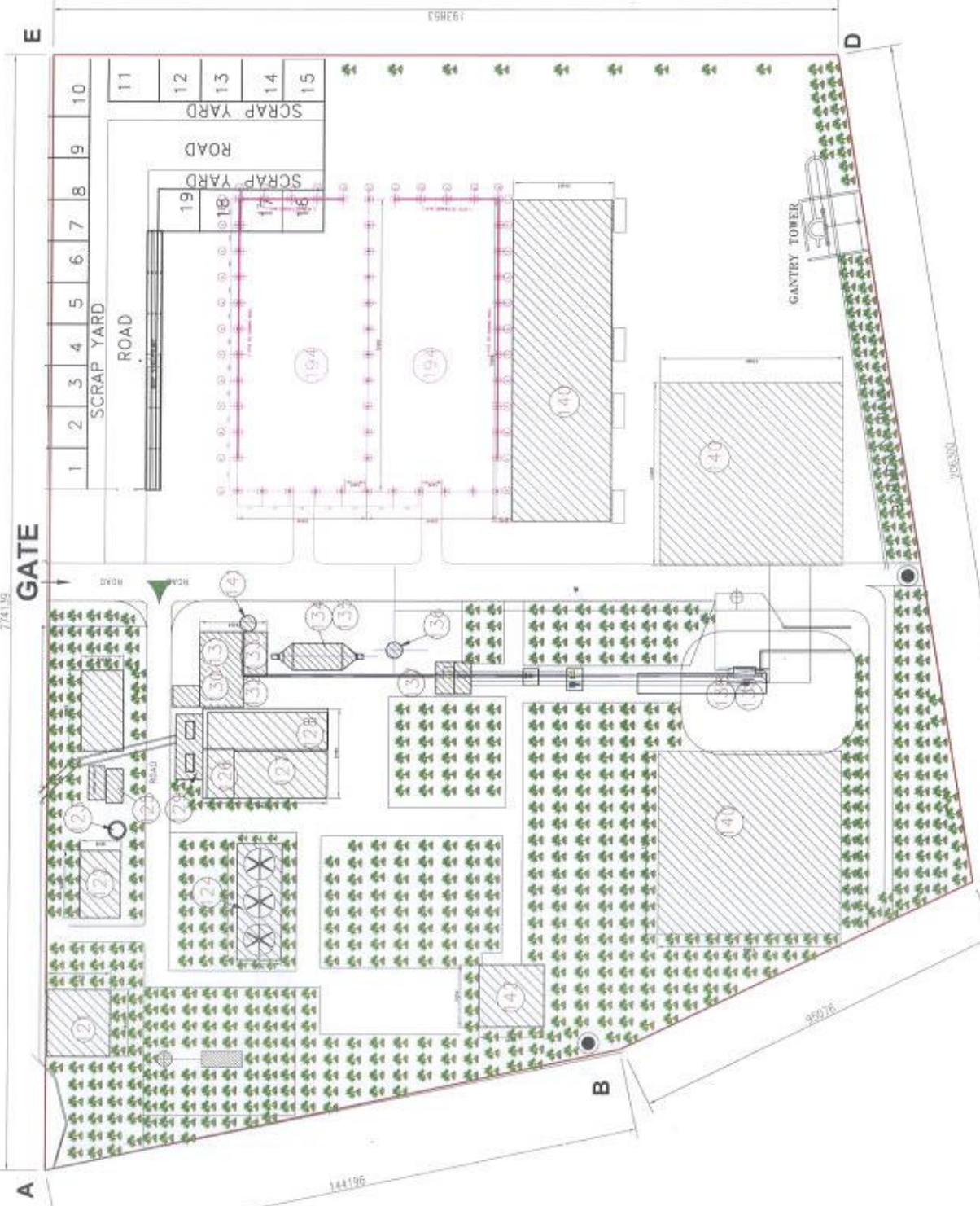

NOTES-
 1. ALL DIMENSIONS ARE IN METERS UNLESS OTHERWISE SPECIFIED.
 2. DONOT SCALE THE DIMENSIONS. IN CASE OF DOUBT, PLEASE ASK.

J.K.WHITE CEMENT WORKS,GOTAN	
DRWN. MADHYA S.	TITLE
DATE 16-08-14	THERMAL POWER PLANT PLANTATION LAYOUT
DESIGNED BY MADHYA	PROJECT
APPROVED	SEC. No - IPP-31/14
SCALE 1:500	REV. No - A
SEC. No - JKWC-IPP-10-64	ACAD FILE-

AREA = 5255.8 sqm
 = 56285.7sqft
 = 31.4 Hect
 = 5.35 Hect
 = 12.97 Acres



REV. NO.	DATE	DESCRIPTION	BY	CHK.
A	27.4.2023	PETRO COKE COVERED SHED	PANJAL	

Photographs of TPP Plant

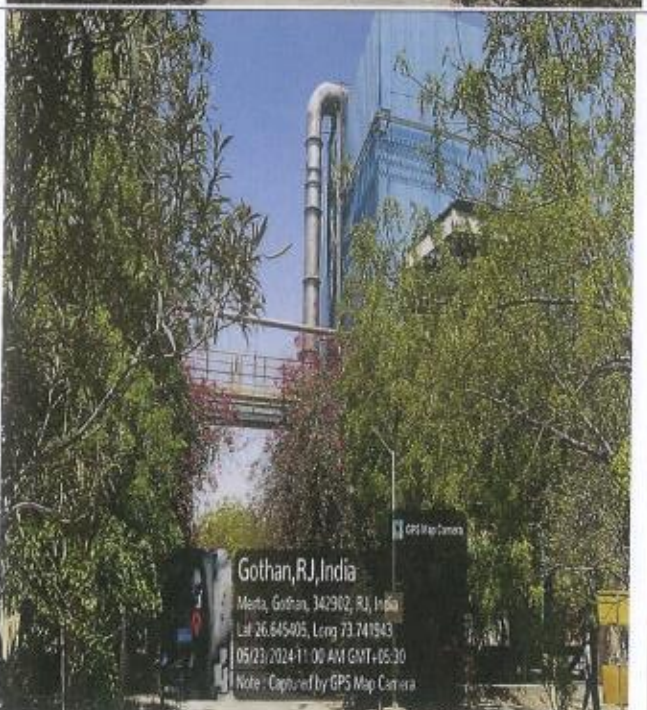
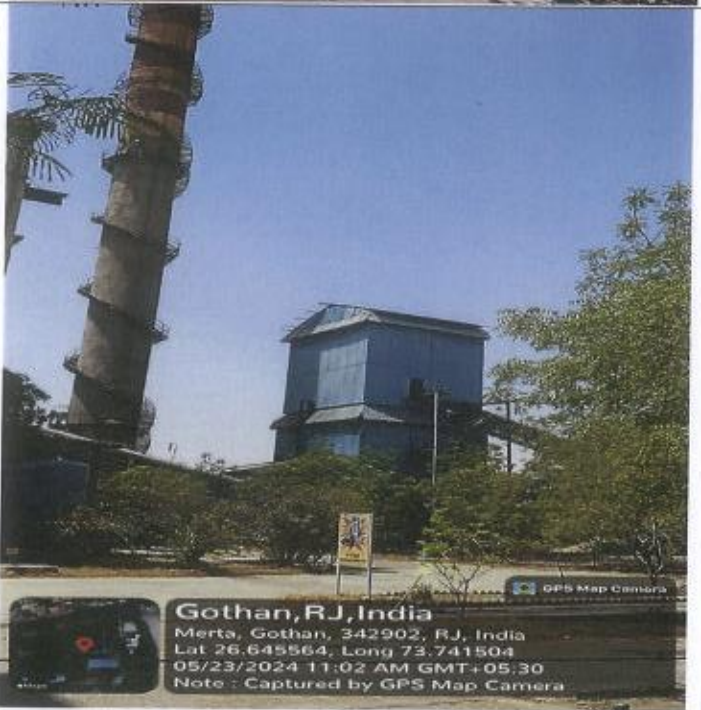

Photographs of Green Belt Development

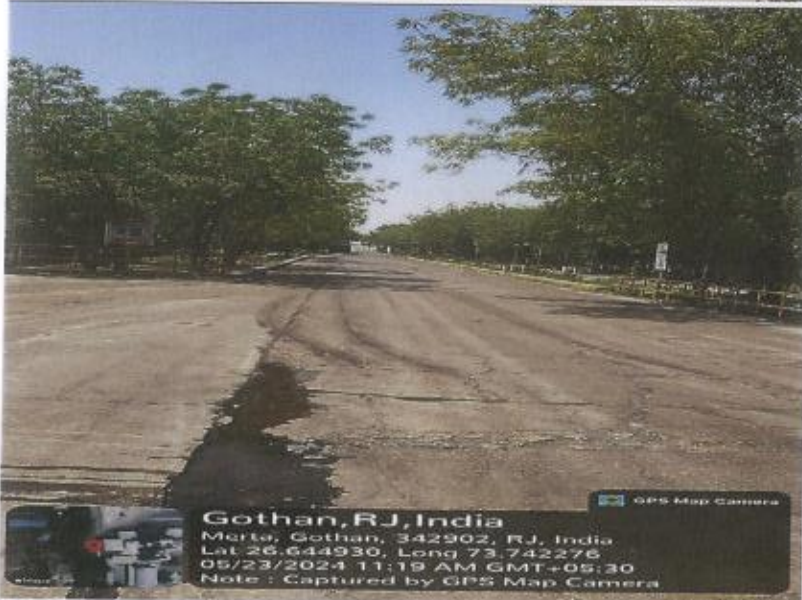
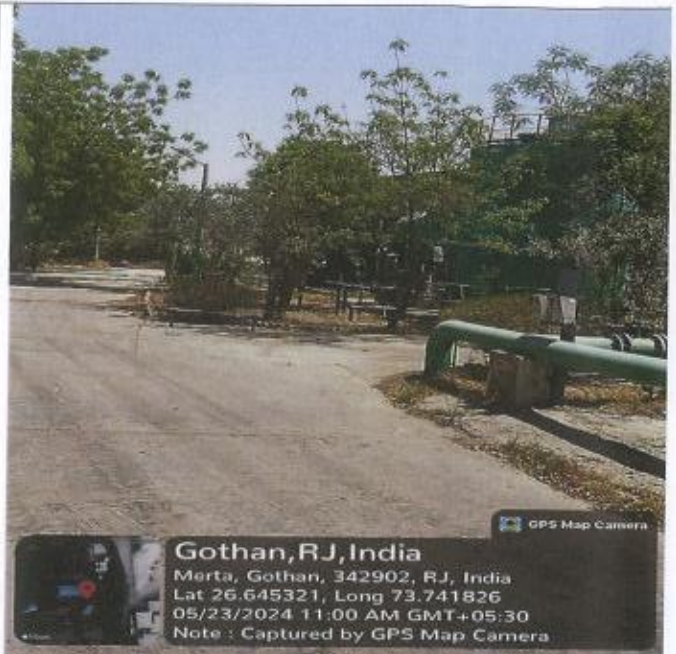

Water Consumption Details

Water Consumption	
Month	Total Water Consumption (KL)
Oct-23	0
Nov-23	0
Dec-23	0
Jan-24	0
Feb-24	0
Mar-24	0
TOTAL	0

*Plant under
shutdown*

Photograph Of Rain Water Harvesting Pit

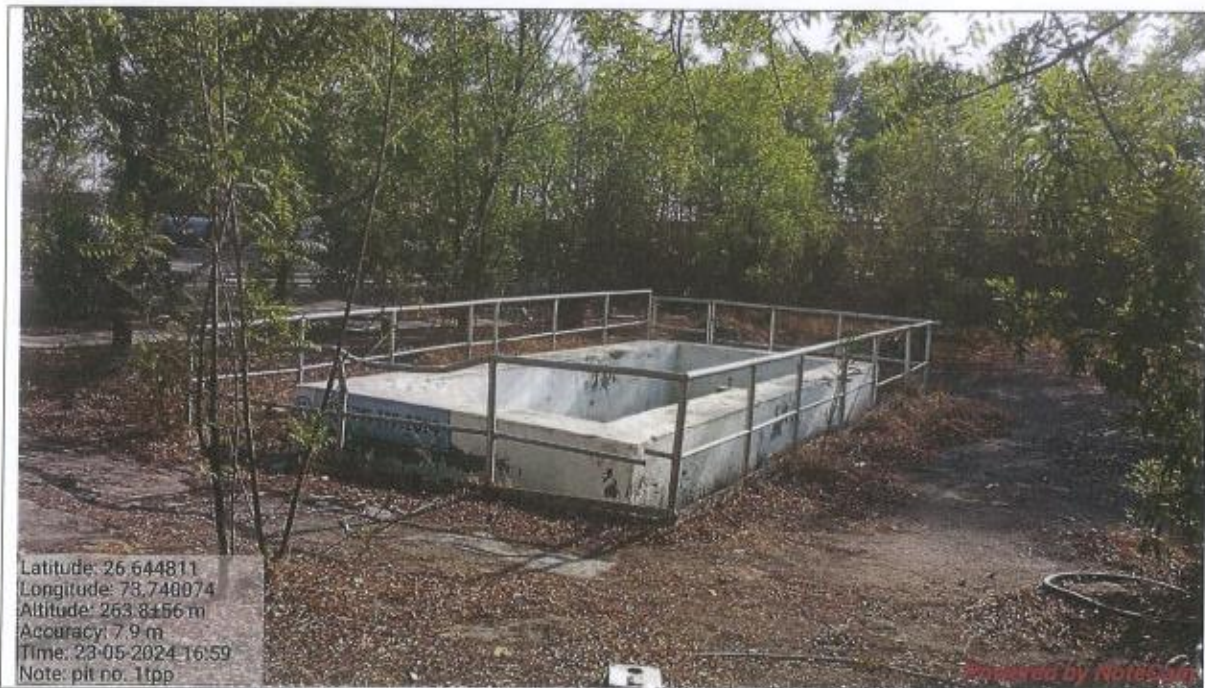

ANNEXURE: 3

Plant/Site

JK White Cement Works, Gotan FY 23-24

Plant/Site	Employee Name	AUDIOMET RY	Blood Group	DISTANT VISION LEFT	DISTANT VISION RIGHT	ECG REPORT	HEIG HT	NEAR VISION LEFT	NEAR VISION RIGHT	SPIROMET RY	WEIGHT
Gotan-White	ABDUL KHAN	NORMAL	A+VE	6/6 GLAS	6/6 GLAS	NORMAL	165	N-6 GLS	N-6 GLS	NORMAL	79
Gotan-White	ABHISHEK JOSHI	ML BE	O+VE	6/6 C GLASS	6/6 C GLASS	NORMAL	182	N-6 C GLASS	N-6 C GLASS	MILD REST	82
Gotan-White	AJAY KUMAR	NORMAL	B+VE	6/6 C GLS	6/6 C GLS	NORMAL	181	N-6	N-6	NORMAL	78
Gotan-White	AJIT MISHRA	NORMAL	O+VE	6/6	6/6	NORMAL	182	N-6	N-6	NORMAL	105
Gotan-White	Akash Bohra	NORMAL	A+VE	6/9 CGLASS	6/9 CGLASS	NORMAL	168	N-6	N-6	NORMAL	61
Gotan-White	AKASH VERMA	NORMAL	B+VE	6/6	6/6	NORMAL	166	N-6	N-6	NORMAL	57
Gotan-White	AMAN JOSHI	NORMAL	B+VE	6/6	6/6	NORMAL	176	N/6	N/6	NORMAL	76
Gotan-White	AMIT KUMAR SHARMA	NORMAL	A+VE	6/6	6/6	NORMAL	168	N-6	N-6	NORMAL	75.9
Gotan-White	ANIL KUMAR	NORMAL	B+VE	6/6 C GLS	6/6 C GLS	NORMAL	174	N-6 C GLS	N-6 C GLS	MILD REST	81
Gotan-White	ANKIT NAVAL	NORMAL	A+VE	6/6	6/6	NORMAL	172	N-6	N-6	NORMAL	73.4
Gotan-White	ANSHU SHARMA	NORMAL	O+VE	6/6	6/6	NORMAL	166	N-6	N-6	NORMAL	74
Gotan-White	APEKSHA PANDEY	NORMAL	A+VE	6/6 C GLS	6/6 C GLS	NORMAL	162	N-6	N-6	NORMAL	61
Gotan-White	ARADHYA SHARMA	NORMAL	O+VE	6/6 GLS	6/6 GLS	NORMAL	166	N-6 GLS	N-6 GLS	NORMAL	76
Gotan-White	ARJUN KUMAR MALI	NORMAL	B+VE	6/6 C GLASS	6/6 C GLASS	NORMAL	165	N-6 C GLS	N-6 C GLS	NORMAL	85.8
Gotan-White	Arun Kumar Saxena	ML BE	O -VE	6/6	6/6	NORMAL	169	N-6 GLS	N-6 GLS	MILD REST	67.5
Gotan-White	ARVIND PUROHIT	NORMAL	A+VE	6/6	6/6	NORMAL	181	N-6	N-6	NORMAL	75
Gotan-White	ASHUTOSH BHARDWAJ	NORMAL	B+VE	6/6 C GLASS	6/6 C GLASS	NORMAL	172	N-6 C GLASS	N-6 C GLASS	NORMAL	95
Gotan-White	ASHUTOSH UPADHYAY	NORMAL	AB+VE	6/6	6/6	NORMAL	169	N-6	N-6	MILD REST	74
Gotan-White	ASLAM KHAN	NORMAL	AB+VE	6/6 CGLASS	6/6 CGLASS	NORMAL	177	N-6 CGLASS	N-6 CGLASS	MILD REST	79
Gotan-White	B S BHADARIA	NORMAL	AB+VE	6/6 GLS	6/6 GLS	NORMAL	174	N-8 GLS	N-8GLS	MILD REST	78
Gotan-White	BABU KHAN	NORMAL	O+VE	6/6 C GLASS	6/6 C GLASS	NORMAL	171	N-6 C GLASS	N-6 C GLASS	NORMAL	86
Gotan-White	BABU LAL	NORMAL	A+VE	6/9	6/9	NORMAL	166	N-6	N-6	MILD REST	73
Gotan-White	BABU LAL	NORMAL	O+VE	6/6GLS	6/6 GLS	NORMAL	167	N-8 GLS	N-8 GLS	MILD REST	73
Gotan-White	BHAGWATI PRASAD	ML BE	B+VE	6/6 GLS	6/6 GLS	NORMAL	168	N-6	N-6	NORMAL	61.8
Gotan-White	BHAGWATI PRASAD GUPTA	NORMAL	B+VE	6/6 GLS	6/6 GLS	NORMAL	162	N-6 GLS	N-6 GLS	NORMAL	70
Gotan-White	BHANWAR SINGH	NORMAL	O+VE	6/6	6/6	NORMAL	169	N-6 CGLASS	N-6 CGLASS	NORMAL	82
Gotan-White	BHANWAR SINGH	NORMAL	O+VE	6/6	6/6	NORMAL	169	N-6 CGLASS	N-6 CGLASS	NORMAL	82
Gotan-White	BHARAT KUMAR	NORMAL	B+VE	6/6 C GLS	6/6 C GLS	NORMAL	166	N-6 C GLS	N-6 C GLS	NORMAL	67.6
Gotan-White	BHASKAR MEHTA	NORMAL	A+VE	6/6	6/6	NORMAL	163	N-6	N-6	NORMAL	69
Gotan-White	BHAWANI SINGH RATHORE	NORMAL	O-VE	6/6	6/6	NORMAL	169	N-6	N-6	NORMAL	98.5
Gotan-White	BHERU NATH	ML LE	B+VE	6/9	6/9	NORMAL	162	N-6	N-6	MILD REST	51
Gotan-White	BHIKA RAM	NORMAL	A- VE	6/6	6/6	NORMAL	179	N-8	N-8	NORMAL	83
Gotan-White	BIRA SINGH	NORMAL	B+VE	6/9	6/9	NORMAL	169.5	N-6	N-6	NORMAL	84
Gotan-White	BIRMA RAM	NORMAL	B+VE	6/6	6/6	NORMAL	157	N-6	N-6	NORMAL	50
Gotan-White	BRIJ GOPAL SEWAG	NORMAL	A+VE	6/6	6/6	NORMAL	179	N-6	N-6	MILD REST	128



Gotan-White	BRIJ KISHOR KANAUIJA	ML BE	B+VE	6/6 C GLS	6/6 C GLS	NORMAL	170	N-8 C GLS	N-8 C GLS	MILD REST	93
Gotan-White	BRIJESH CHOUDHARY	NORMAL	O+VE	6/6	6/6	NORMAL	172	N-6	N-6	NORMAL	84
Gotan-White	CHAILA RAM	NORMAL	AB+VE	6/9	6/9	NORMAL	160	N-8 C GLS	N-8 C GLS	MILD REST	62
Gotan-White	DALPAT RAM PARIHAR	NORMAL	O+VE	6/6	6/6	NORMAL	165	N-6	N-6	MILD REST	79
Gotan-White	DANA RAM	NORMAL	B+VE	6/6 CGLASS	6/6 CGLASS	NORMAL	167	N-6 GLS	N-6 GLS	MILD REST	58
Gotan-White	DEEPAK BABBAR	NORMAL	B+VE	6/6 C GLS	6/6 C GLS	NORMAL	178	N-6 C GLS	N-6 C GLS	NORMAL	91.8
Gotan-White	DEEPAK KHABYA	NORMAL	B+VE	6/6	6/6	NORMAL	172.5	N-6	N-6	NORMAL	51
Gotan-White	DESH RAJ	ML BE	A+VE	6/9	6/9	NORMAL	166	N-6	N-6	MILD REST	62
Gotan-White	DEVA RAM	ML BE	O+VE	6/6 GLS	6/9 GLS	NORMAL	162	N-6 GLS	N-6 GLS	MILD REST	71
Gotan-White	DEVENDRA KUMAR DAS	ML BE	B +VE	6/6	6/6	NORMAL	170	N-6 C GLASS	N-6 C GLASS	MILD REST	83
Gotan-White	DHANRAJ CHOUDHARY	NORMAL	O+VE	6/6	6/6	NORMAL	174	N-6	N-6	MILD REST	78
Gotan-White	DHARMENDRA DUTTA PUROHIT	NORMAL	A+VE	6/6	6/6	NORMAL	179	N-6	N-6	MILD REST	97
Gotan-White	DILIP KUMAR	NORMAL	B+VE	6/9 C GLASS	6/6 C GLASS	NORMAL	162	N-6	N-6	NORMAL	71.4
Gotan-White	DILIP SHARMA	NORMAL	AB+VE	6/6 C GLASS	6/6 C GLS	NORMAL	158	N-6 C GLS	N-6 C GLS	NORMAL	66
Gotan-White	FATEH SINGH RATHOR	NORMAL	O+VE	6/6	6/6	NORMAL	177	N-6	N-6	MILD REST	73
Gotan-White	GAJENDRA PANWAR	NORMAL	B+VE	6/6	6/6	NORMAL	166	N-6	N-6	NORMAL	63
Gotan-White	GAJENDRA SINGH SHEKHAWAT	NORMAL	O+VE	6/6	6/6	NORMAL	173	N-6	N-6	MILD REST	81.5
Gotan-White	GAURAV SHARMA	NORMAL	AB+VE	6/6	6/6	NORMAL	169	N-6	N-6	NORMAL	74
Gotan-White	Geetanjali Dadhech	NORMAL	B+VE	6/6 CGLASS	6/6 CGLASS	NORMAL	164	N-6 CGLASS	N-6 CGLASS	NORMAL	75
Gotan-White	GIRJESH KUMAR AGRAWAT	NORMAL	O-VE	6/6	6/6	NORMAL	175	N-6	N-6	NORMAL	86
Gotan-White	GODHA RAM	ML BE	A-VE	6/9 GLS	6/9 GLS	NORMAL	165	N-6 GLS	N-6 GLS	NORMAL	74.8
Gotan-White	GOPA RAM	NORMAL	O+VE	6/9 C GLS	6/9 C GLS	NORMAL	174	N-8 C GLS	N-8 C GLS	MILD REST	74
Gotan-White	GOUTAM RATAWA	ML BE	B+VE	6/6 C GLASS	6/6 CGLASS	NORMAL	159	N-6 CGLASS	N-6 CGLASS	NORMAL	50
Gotan-White	GYANCHAND SARGARA	NORMAL	A+VE	6/6	6/6	NORMAL	161	N-6	N-6	NORMAL	74
Gotan-White	HARENDRA SHARMA	NORMAL	B+VE	6/6	6/6	NORMAL	165	N-6	N-6	NORMAL	104
Gotan-White	HARISH CHANDRA PRAJAPATI	NORMAL	A+VE	6/6	6/6	NORMAL	174	N-6	N-6	MILD REST	77.9
Gotan-White	HEER SINGH SHEKHAWAT	ML BE	A+VE	6/6 C GLS	6/6 C GLS	NORMAL	170	N-6 C GLS	N-6 C GLS	MILD REST	85
Gotan-White	IMRAN NAZIR KHAN	NORMAL	O + VE	6/6	6/6	NORMAL	162	N-6	N-6	NORMAL	67
Gotan-White	IPPILI NAGENDRA KUMAR	NORMAL	o+ve	6/6 C GLS	6/6 c gls	NORMAL	171	N-6 c gls	N-6 c gls	NORMAL	85
Gotan-White	JAGDISH CHAND	NORMAL	AB+VE	6/6 C GLASS	6/6 C GLASS	NORMAL	177	N-6 C GLS	N-6 C GLS	NORMAL	76
Gotan-White	JAGDISH CHANDRA PRAJAPATI	NORMAL	O+VE	6/6	6/6	NORMAL	175	N-6	N-6	NORMAL	79
Gotan-White	JAGDISH NAI	NORMAL	B+VE	6/6 GLS	6/6 GLS	NORMAL	171	N-6 GLS	N-6 GLS	NORMAL	74
Gotan-White	JAI PRAKASH OJHA	ML RE	A+VE	6/6	6/6	NORMAL	166	N-6	N-6	NORMAL	73
Gotan-White	JASSA RAM	ML BE	A+VE	6/9	6/9	NORMAL	166	N-6	N-6	NORMAL	72
Gotan-White	JAY PRAKASH	NORMAL	A+VE	6/6	6/6	NORMAL	168	N-6	N-6	MILD REST	77.5
Gotan-White	JITENDRA SINGH	NORMAL	O+VE	6/6	6/6	NORMAL	163	N-6	N-6	MILD REST	64
Gotan-White	JOGI RAM	ML BE	B-VE	6/6	6/6	NORMAL	176	N-6	N-6	NORMAL	85



Gotan-White	KAILASH CHANDRA SHARMA	NORMAL	A+VE	6/6	6/6	NORMAL	173	N-6	N-6	NORMAL	101.8
Gotan-White	KAILASH NATH	NORMAL	B+VE	6/6	6/6	NORMAL	157	N-6	N-6	NORMAL	46
Gotan-White	KALYAN DAS BAIRAGI	NORMAL	A+VE	6/6	6/6	NORMAL	167	N-6	N-6	MILD REST	80
Gotan-White	KALYAN RAM HAMBER	NORMAL	O+VE	6/6	6/6	NORMAL	162	N-6	N-6	NORMAL	60
Gotan-White	KAMAL JETHWANI	NORMAL	B+VE	6/6	6/6	NORMAL	178	N-6	N-6	NORMAL	72
Gotan-White	KAMAL KISHOR	NORMAL	A+VE	6/6 GLS	6/6 GLS	NORMAL	173	N-6 GLS	N-6GLS	NORMAL	71.5
Gotan-White	KAMAL VAISHNAV	NORMAL	A-VE	6/6	6/6	NORMAL	181	N-6	N-6	MILD REST	79
Gotan-White	KANHIYA NATH YOGI	NORMAL	B+VE	6/6	6/6	NORMAL	172	N-6	N-6	NORMAL	96
Gotan-White	KESHA RAM	ML BE	O+VE	6/9	6/9	NORMAL	172	N-8 C GLS	N-8 C GLS	MILD REST	110
Gotan-White	KESHAV SHARMA	NORMAL	B+VE	6/6	6/6	NORMAL	176	N-6	N-6	NORMAL	67
Gotan-White	KHALIL AHAMAD	NORMAL	AB+VE	6/9	6/9	NORMAL	170	N-8 C GLS	N-8 C GLS	NORMAL	63
Gotan-White	Khemandra Pal Singh	NORMAL	B+VE	6/9	6/9	NORMAL	171	N-6	N-6	NORMAL	78
Gotan-White	Kherajram Chowdhary	NORMAL	O+VE	6/6 GLS	6/6 GLS	NORMAL	178	N-6 GLS	N-6 GLS	NORMAL	89
Gotan-White	KHETA RAM	NORMAL	O+VE	6/6 GLS	6/6 GLS	NORMAL	162	N-6 G:LS	N-6 GLS	MILD REST	58
Gotan-White	KHOWENDRA DAYARAM JADHAV	NORMAL	B+VE	6/6 GLS	6/6 GLS	NORMAL	164	N-6GLS	N-6 GLS	NORMAL	59
Gotan-White	KISHAN LAL	ML BE	O+VE	6/6	6/6	NORMAL	174	N-6	N-6	NORMAL	63
Gotan-White	KISHORE DHAKAR	NORMAL	O+VE	6/6 GLS	6/6 GLS	NORMAL	168	N-6 GLS	N-6 GLS	NORMAL	71
Gotan-White	KRISHNA KANT DAIYA	NORMAL	O+VE	6/6	6/6	NORMAL	173	N-6	N-6	NORMAL	87
Gotan-White	Kriti Sheen	NORMAL	AB+VE	6/6 GLS	6/6 GLS	NORMAL	163	N-6 GLS	N-6 GLS	NORMAL	67
Gotan-White	LAL SINGH	NORMAL	A+VE	6/6GLS	6/6GLS	NORMAL	174	N-6 c gls	N-6 c gls	NORMAL	71
Gotan-White	LALIT GARG	NORMAL	B+VE	6/6	6/6	NORMAL	176	N-6	N-6	NORMAL	79
Gotan-White	Laxman Singh	NORMAL	B+VE	6/6	6/6	NORMAL	180	N-6	N-6	NORMAL	82
Gotan-White	LAXMAN SINGH	NORMAL	B+VE	6/6 C GLS	6/9 C GLS	NORMAL	172	N-8C GLS	N-8C GLS	MILD REST	51.8
Gotan-White	LIVANJALI DATA	NORMAL	B+VE	6/6 C GLS	6/6 C GLS	NORMAL	150	N-6	N-6	NORMAL	60
Gotan-White	LOKESH	NORMAL	A+VE	6/6 C GLASS	6/6 C GLASS	NORMAL	177	N-6 C GLASS	N-6 C GLASS	NORMAL	96
Gotan-White	LOKESH VERMA	NORMAL	A+VE	6/6 C GLASS	6/6 C GLASS	NORMAL	181	N-6 C GLASS	N-6 C GLASS	NORMAL	79
Gotan-White	MAHESH KUMAR BHAMBI	NORMAL	O+VE	6/6	6/6	NORMAL	160	N-6	N-6	NORMAL	65
Gotan-White	MANGI LAL KARWASRA	NORMAL	AB+VE	6/9	6/9	NORMAL	158.5	N-6 CGLASS	N-6 CGLASS	NORMAL	57
Gotan-White	MANISH PRAJAPAT	NORMAL	AB +VE	6/6	6/6	NORMAL	171	N-6	N-6	NORMAL	76
Gotan-White	MANISH TODWAL	NORMAL	B+VE	6/6	6/6	NORMAL	164	N-6	N-6	NORMAL	79
Gotan-White	MANMOHAN SINGH RATHOR	NORMAL	A+VE	6/6	6/6	NORMAL	167	N-6	N-6	MILD REST	64.8
Gotan-White	MANOJ KUMAR	NORMAL	A+VE	6/6	6/6	NORMAL	167	N-6 GLS	N-6 GLS	MILD REST	73
Gotan-White	MATA DEEN	NORMAL	A+VE	6/6 C GLS	6/6 C GLS	NORMAL	153	N-6 C GLS	N-6 C GLS	NORMAL	66.5
Gotan-White	MOHAN SINGH	NORMAL	AB+VE	6/6 GLS	6/6 GLS	NORMAL	165	N-6GLS	N-6 GLS	NORMAL	67
Gotan-White	MOINUDDIN BANGREJ	NORMAL	O+VE	6/6	6/6	NORMAL	175	N-6	N-6	MILD REST	82
Gotan-White	MUKESH KATHAT	NORMAL	B+VE	6/6	6/6	NORMAL	174	N-6	N-6	MILD REST	90
Gotan-White	MUKESH MATHUR	NORMAL	B+VE	6/6	6/6	NORMAL	179	N-6	N-6	NORMAL	52



Gotan-White	NAINA RAM	NORMAL	B+VE	6/6	6/6	NORMAL	166	N-6 C GLS	N-6 C GLS	MILD REST	75
Gotan-White	NARAYAN LAL SHARMA	ML BE	O+VE	6/6 CGLASS	6/6 CGLASS	NORMAL	173	N-6 CGLASS	N-6 CGLASS	NORMAL	68
Gotan-White	NARENDRA SUTHAR	NORMAL	B-VE	6/6	6/6	NORMAL	171	N-6	N-6	MILD REST	53
Gotan-White	NEERAJ KUMAR KARAN	NORMAL	O+VE	6/6	6/6	NORMAL	164	N-6 GLS	N-6 GLS	NORMAL	70
Gotan-White	NITESH GUPTA	NORMAL	O+VE	6/6 GLS	6/6 GLS	NORMAL	161	N-6 GLS	N-6 GLS	NORMAL	65.5
Gotan-White	OM PRAKASH	ML BE	A+ve	6/6	6/6	NORMAL	164	N-6	N-6	MILD REST	64
Gotan-White	OM PRAKASH GURJAR	NORMAL	O+VE	6/9 CGLASS	6/9 CGLASS	NORMAL	172	N-6 CGLASS	N-6 CGLASS	NORMAL	69.3
Gotan-White	OM PRAKASH JOSHI	ML BE	O+VE	6/6 C GLS	6/6 C GLS	NORMAL	173	N-6	N-6	MILD REST	74
Gotan-White	OM PRAKASH SHARMA	NORMAL	AB+VE	6/6 CGLASS	6/6 CGLASS	NORMAL	171.5	N-6 CGLASS	N-6 CGLASS	MILD REST	70
Gotan-White	ONKAR LAL ANJANA	NORMAL	B+VE	6/6	6/6	NORMAL	174	N-6	N-6	NORMAL	85
Gotan-White	ONKAR NATH PANDEY	NORMAL	A+VE	6/6 C GLASS	6/6 C GLASS	NORMAL	168	N-6 C GLASS	N-6 C GLASS	MILD REST	79
Gotan-White	PARMANAND SHARMA	NORMAL	B+VE	6/6	6/6	NORMAL	178	N-6	N-6	NORMAL	97
Gotan-White	PAWAN KUMAR	NORMAL	O+VE	6/6	6/6	NORMAL	172	N-6 CGLASS	N-6 CGLASS	NORMAL	89
Gotan-White	PEEYUSH SHARMA	NORMAL	O+VE	6/6 C GLASS	6/6 C GLASS	NORMAL	162	N-6 C GLASS	N-6 C GLASS	NORMAL	76.8
Gotan-White	POKAR RAM	ML LE	O+VE	6/9 GLS	6/9 GLS	NORMAL	161	N-6 GLS	N-6 GLS	MILD REST	77
Gotan-White	PRAHLAD RAM SHARMA	NORMAL	B+VE	6/6 C GLASS	6/6 C GLASS	NORMAL	178	N-6 C GLASS	N-6 C GLASS	NORMAL	86
Gotan-White	PRAKASH GUJAR	NORMAL	O+VE	6/6	6/6	NORMAL	173	N-6	N-6	NORMAL	72
Gotan-White	PRATHVI RAJ PUROHIT	NORMAL	A+VE	6/6 C GLS	6/6 C GLS	NORMAL	172	N-6 C GLS	N-6 C GLS	MILD REST	68.16
Gotan-White	Praveen Pancholi	NORMAL	B+VE	6/6	6/6	NORMAL	161	N-6	N-6	NORMAL	69.8
Gotan-White	Praveen Singh	NORMAL	A+VE	6/6	6/6	NORMAL	172	N-6	N-6	NORMAL	84
Gotan-White	PRAVEEN SINGH	NORMAL	A-VE	6/6	6/6	NORMAL	159	N-8 C GLS	N-8 C GLS	MILD REST	73
Gotan-White	PREM SINGH SHEKHAWAT	NORMAL	A+VE	6/6 CGLASS	6/6 CGLASS	NORMAL	167	N-6 CGLASS	N-6 CGLASS	MILD REST	73.6
Gotan-White	PURAN CHAND CHAWLA	NORMAL	O+VE	6/6 CGLASS	6/6 CGLASS	NORMAL	160	N-6 C GLS	N-6 C GLS	MILD REST	89
Gotan-White	PUSHPENDRA SINGH CHOUHAN	NORMAL	O+VE	6/6	6/6	NORMAL	170	N-6	N-6	NORMAL	83
Gotan-White	RADHEY SHYAM	NORMAL	B-VE	6/6	6/6	NORMAL	161	N-8 CGLASS	N-6 CGLASS	NORMAL	72.9
Gotan-White	RAHUL BHAMBHI	NORMAL	O+VE	6/6	6/6	NORMAL	166	N-6	N-6	MILD REST	55
Gotan-White	Rahul Bhardwaj	NORMAL	AB+VE	6/6	6/6	NORMAL	170	N-6	N-6	NORMAL	81
Gotan-White	RAHUL JAIN	NORMAL	B+VE	6/6	6/6	NORMAL	184	N-6	N-6	NORMAL	98
Gotan-White	RAHUL SAIN	NORMAL	A+VE	6/6	6/6	NORMAL	178	N-6	N-6	NORMAL	104
Gotan-White	RAJESH KUMAR MAURYA	NORMAL	O+VE	6/6GLS	6/6 GLS	NORMAL	169	N-6 GLS	N-6 GLS	NORMAL	57.8
Gotan-White	RAKESH KUMAR MADAN	NORMAL	O+VE	6/6 C GLS	6/6 C GLS	NORMAL	181.5	N-6 C GLS	N-6 C GLS	NORMAL	90
Gotan-White	RAM CHANDRA KARWASRA	NORMAL	O+VE	6/9 CGLASS	6/9 C GLASS	NORMAL	175	N-8 GLS	N-8 GLS	NORMAL	95
Gotan-White	RAM DEV VYAS	NORMAL	B+VE	6/9 C GLS	6/9 C GLS	NORMAL	165	N-8 C GLS	N-8 C GLS	NORMAL	68
Gotan-White	RAM LAL	NORMAL	O+VE	6/6	6/6	NORMAL	167	N-6C GLASS	N-6C GLASS	NORMAL	73
Gotan-White	RAM NIWAS	NORMAL	B+VE	6/6	6/6	NORMAL	165	N-8 C GLS	N-8 C GLS	NORMAL	86
Gotan-White	RAM NIWAS JALWANIA	NORMAL	B+VE	6/6	6/6	NORMAL	176	N-6 C GLASS	N-6 C GLASS	NORMAL	78
Gotan-White	RAM NIWAS SANGWA	NORMAL	B+VE	6/6 CGLASS	6/6 CGLASS	NORMAL	177	N-6 GLS	N-6 GLS	NORMAL	86



Gotan-White	RAM PARSAD	NORMAL	B+VE	6/9 C GLS	6/9C GLS	NORMAL	165	N-8 C GLS	N-6 C GLS	NORMAL	58
Gotan-White	RAM PRAKASH	NORMAL	A+VE	6/6	6/6	NORMAL	169	N-6 C GLS	N-6 C GLS	MILD REST	76
Gotan-White	SAFI MOHD.	NORMAL	B+VE	6/6	6/6	NORMAL	168	N-6 C GLS	N-8 C GLS	NORMAL	63
Gotan-White	SAHI RAM	ML BE	A -VE	6/9	6/9	NORMAL	169	N-6	N-6	MILD REST	80
Gotan-White	SANJAY KASERA	NORMAL	B+VE	6/6	6/6	NORMAL	179	N-6	N-6	NORMAL	77
Gotan-White	SARDARA RAM CHOUDHARY	NORMAL	B+VE	6/6	6/6	NORMAL	174	N-6 GLS	N-6 GLS	NORMAL	90
Gotan-White	SAROJ KUMAR SINGH	NORMAL	A+VE	6/6 CGLASS	6/6 CGLASS	NORMAL	164	N-6 CGLASS	N-6 CGLASS	NORMAL	73
Gotan-White	SATISH KUMAR	ML BE	B+VE	6/6	6/6	NORMAL	170	N-6 GLS	N-6 GLS	NORMAL	64.8
Gotan-White	SATYANDRA SINGH SONAGARA	NORMAL	B-VE	6/6	6/6	NORMAL	183	N-6	N-6	NORMAL	74
Gotan-White	SATYENDRA KUMAR MALAV	NORMAL	B+VE	6/6	6/6	NORMAL	169	N-6	N-6	NORMAL	61
Gotan-White	SATYENDRA KUMAR PANDEY	NORMAL	O+VE	6/6 CGLASS	6/6 CGLASS	NORMAL	171	N-6 CGLASS	N-6 CGLASS	MILD REST	73
Gotan-White	SAYAR RAM	NORMAL	B+VE	6/6 CGLASS	6/9 C GLASS	NORMAL	175	N-6 C GLASS	N-6 C GLASS	MILD REST	85
Gotan-White	SHAFIK ALI	NORMAL	B+VE	6/6 CGLASS	6/6 CGLASS	NORMAL	165	N-6 CGLASS	N-6 CGLASS	NORMAL	81
Gotan-White	SHAILENDRA KUMAR PUROHIT	NORMAL	O+VE	6/6 CGLASS	6/6 CGLASS	NORMAL	162.5	N-6 CGLASS	N-6 CGLASS	NORMAL	68.6
Gotan-White	SHALINI SABU	NORMAL	O+VE	6/6 C GLASS	6/9 C GLASS	NORMAL	151	N-6 C GLASS	N-8 C GLASS	MILD REST	63
Gotan-White	Sharawan Kumar Pandey	NORMAL	O+VE	6/6	6/6	NORMAL	164	N-6	N-6	NORMAL	73
Gotan-White	SHELENDRA TODWAL	NORMAL	B+VE	6/6	6/6	NORMAL	169	N-8 C GLS	N-8 C GLS	NORMAL	72
Gotan-White	SHISHPAL CHOUDHARY	NORMAL	A+VE	6/6	6/6	NORMAL	167	N-6	N-6	NORMAL	77
Gotan-White	SHRI NATH PANDEY	NORMAL	B+VE	6/6 CGLASS	6/6 CGLASS	NORMAL	176	N-6 CGLASS	N-6 CGLASS	MILD REST	85
Gotan-White	SHRI RAM SHARMA	NORMAL	A+VE	6/6 CGLASS	6/6 CGLASS	NORMAL	174	N-6 CGLASS	N-6 CGLASS	NORMAL	78.9
Gotan-White	SHYAM LAL SUTHAR	NORMAL	A+VE	6/6 C GLS	6/6 C GLS	NORMAL	174	N-6 C GLS	N-6 C GLS	NORMAL	100
Gotan-White	SHYAM SINGH	ML BE	D+VE	6/6	6/6	NORMAL	173	N-8	N-8	NORMAL	73
Gotan-White	SRI RAM	NORMAL	A + VE	6/6	6/6	NORMAL	165	N-6 C GLASS	N-6 C GLASS	NORMAL	73
Gotan-White	SUGNA RAM	NORMAL	D-VE	6/9 C GLS	6/9 GLS	NORMAL	175	N-8 C GLS	N-8 C GLS	MILD REST	80
Gotan-White	SURENDER SINGH RATHORE	NORMAL	A+VE	6/6 GLS	6/6 GLS	NORMAL	162	N-6 GLS	N-6 GLS	NORMAL	63
Gotan-White	SURYAPRAKASH CHOUDHARY	NORMAL	O+VE	6/6	6/6	NORMAL	182	N-6	N-6	NORMAL	81
Gotan-White	SUSHIL KUMAR TAK	NORMAL	B+VE	6/6	6/9	NORMAL	170	N-6	N-6	NORMAL	76
Gotan-White	TEJ PAL SINGH	NORMAL	B+VE	6/6 C GLS	6/9 C GLS	NORMAL	180	N-6 C GLS	N-6 C GLS	MILD REST	79
Gotan-White	VIJAY KHANDELWAL	NORMAL	B+VE	6/6 C GLS	6/6 C GLS	NORMAL	171	N-6 C GLS	N-6 C GLS	NORMAL	82
Gotan-White	VIJAY SONI	NORMAL	B+VE	6/6	6/6	NORMAL	162	N-6	N-6	MILD REST	64.7
Gotan-White	VIKAS KUMAR	NORMAL	O+VE	6/6	6/6	NORMAL	174	N.6	N.6	NORMAL	74
Gotan-White	VIPUL KUMAR OJHA	NORMAL	A+VE	6/6	6/6	NORMAL	169	N-6	N-6	NORMAL	59
Gotan-White	VIRENDRA KUMAWAT	NORMAL	B+VE	6/9 GLS	6/9 GLS	NORMAL	172	N-6 GLS	N- GLS	NORMAL	77
Gotan-White	VIRENDRA SINGH RATHORE	NORMAL	A+VE	6/6 C GLS	6/6 C GLS	NORMAL	173	N-6 C GLS	N-6 C GLS	MILD REST	65.8
Gotan-White	YOGENDRA VYAS	NORMAL	B+VE	6/6 C GLASS	6/6 C GLASS	NORMAL	155	N-6 C GLASS	N-6 C GLASS	NORMAL	102
Gotan-White	YOGESH NAGAR	NORMAL	B+VE	6/6	6/6	NORMAL	172	N-6	N-6	MILD REST	84

