

REG. A/D & MAIL

JKWC (TPP)/PLNG/ENV/21/

Date: 22.11.2024

The Director,
Ministry of Environment, Forest & Climate Change (Integrated Regional Office),
A-209 & 218, "ARANYA BHAWAN", Jhalana Institutional Area, Jaipur-302004
Email: iro.jaipur-mefcc@gov.in

Subject : Half Yearly Compliance Report of Environmental Clearance conditions of 7.5 MW TPP of M/s JK White Cement Works (Unit of J K Cement Ltd.), situated at P.O. Gotan, Tehsil - Merta, Distt. Nagaur, Rajasthan for the Period from 1st April 2024 to 30th September, 2024.

Ref. : Letter No. J-13012/187/07-IA-II(T) dated 31.12.2007

Dear Sir,

As above subjected matter, submitting herewith the point - wise compliance report of the conditions of environment clearance issued by the board vide letter from MoEF, New Delhi mentioned as reference.

Project Code : Raj - 32/581/08
Name of the Project : 7.5 MW Captive Power Plant
Clearance Letter No. : J-13012/187/07-IA-II(T) dated 31.12.2007.
Period of Compliance : From 1st April 2024 to 30th September, 2024.

COMPLIANCE CONDITIONS:

Sr.	Conditions	Compliance Status
1.	No additional land shall be acquired for any activity relating to the proposed project.	TPP Plant is installed at premises of M/s JK White Cement Works.
2.	Sulphur contents in coal and lignite to be used as fuel for the project shall not exceed 0.7 % and 1.0 % respectively. In the event of the Sulphur content exceeding the prescribed limits, lime treatment shall be given to control SO ₂ emission by at least 90%.	Coal, lignite has been used for power generation having Sulphur content below 0.7% & 1% respectively. If the Sulphur contents are found more than prescribed limit, lime treatment will be given (Limestone/Dolomite feed with coal and achieved emission within limit).
3.	The height of the stack shall be as per the standards prescribed under the Environment (Protection) Act in this regards or 72m, whichever is more with continuous online monitoring system. The exit velocity of the flue shall not be less than 18 m/sec.	Stack of height is 72 meters provided as per board direction. Online Continuous Emission monitoring system is installed at site as per norms. In this compliance period plant was under shutdown.



Corporate Office

- Prism Tower, 5th Floor, Ninaniya Estate, Gwal Pahari, Gurugram - 122102, Haryana
- +0124-6919000
- admin.prismt@jkcement.com
- www.jkcement.com

**JK SUPER
CEMENT**
BUILD SAFE

Manufacturing Units at :

Nimbahera, Mangrol, Gotan (Rajasthan) | Muddapur (Karnataka)
Jharli (Haryana) | Katni, Panna (M.P.) | Aligarh, Hamirpur (U.P.)
Balasinor (Gujarat) | FujalrahJKcement
WallMax
White Cement Based Putty

Registered Office : Kamlu Tower, Kanpur-208001, U.P., India. +91-512-2371478 to 85 91-512-2399854 www.jkcement.com

Jodhpur Office : 182, Gopi Krishna Vihar, Near Guru Ka Talab, Near Pratap Nagar, Jodhpur-342001. +0291-2432021, 2433072

4.	High efficiency electrostatic precipitators (ESPs) shall be installed to limit particulate emission to 100 mg/Nm ³ .	Three stage ESP has been installed. OCEMS installed at site which online are connected with RSPCB & CPCB servers. we are achieving <30 mg/Nm ³ particulate emission
5.	Dust extraction and suppression system and water sprinklers shall be provided for controlling fugitive dust during transportation, in coal /lignite storage & handling area and other vulnerable areas of the plant.	We have already taken care for controlling the fugitive dust emission by adopting the better housekeeping, concreting the movement areas and development of Green belt. Dust collector has been installed at coal crusher & Transfer Tower No. 1 & at Bunker top. Water sprinkle system has been provided at Grizzly Hopper for controlling of dust.
6.	Water requirement shall be met from the saving of water to be achieved with the replacement of DG sets and from STP. No additional water shall be extracted for the project.	Total water requirement of the project is 172 KL/D, out of which 61 KL has been met from STP treated water & 111 KL/D met as substitute of phased out DG set which is presently not in running due to TPP. Above was projected but actual consumption with ACC is very low.
7.	Air cooled condenser shall be provided	Air Cooled Condenser is provided
8.	The treated effluent shall be re-circulated and reused within the plant area. There shall be no waste discharge outside the plant boundary.	Wastewater discharge from various processes from thermal power plant. After proper neutralization/treatment it is used for dust suppression/ coal yard. There is no water discharge outside the plant boundary and maintained ZLD.
9.	Rainwater harvesting shall be practiced. A detailed scheme for rain water harvesting to recharge the ground water aquifer shall be prepared in consultation with Central Ground Water Authority /State Ground Water Board and a copy of the same shall be submitted within three months to this Ministry.	We have maintained rainwater harvesting recharge structures in good condition for ground water recharge according to CGWA guidelines. All details has provided with pervious compliance reports.
10.	Leq of Noise level shall be limited to 75 dB (A) and regular maintenance of equipment's should be undertaken. For people working in high noise areas, personal protection devices should be provided.	Regular noise monitoring shall be ensured around plant boundary within stipulated norms. Recognized approved lab Report of Noise Monitoring As well as self are attached as Annexure-1.
11.	Dry ash collection system shall be provided. 100 % ash utilization shall be ensured from the day one of the commissioning of the plant.	Arrangement for collection of dry ash has been provided. 100 % flyash/Cinder is utilized in our own and sister cement plants as well as for sale to local vendors. Annual audit was conducted by accredited personnel/Institution MNIT, Jaipur which is already submitted
12.	A green belt shall be developed around the plant boundary with tree density of at least 1500 per ha covering 1/3rd of the project area	Green belt developed around the TPP boundary side & nearby area also maintained more then 1/3rd project area. Different type of tree saplings like as Neem, Desi Ashok, Pendular Ashok, Arjun etc. has been planted. Plantation Layout Plan is attached as Annexure-2
13.	First aid and sanitation arrangements shall be	Sanitation facilities for operators/workers have



	made for the drivers and other contract workers during construction.	been provided.
14.	Regular monitoring of the ambient air quality shall be carried out in and around the power plant and records maintained. The location of monitoring stations and frequency of monitoring shall be decided in consultation with the State Pollution Control Board. Periodic reports shall be submitted to the Regional Office of this Ministry at Lucknow.	The TPP is in the same premises of J K White Cement Works hence four manual AAQM stations are monitored regularly in consultation with Regional Office for the parameters of SPM/PM10/PM2.5, SO2, NOx & CO and results are well within the prescribed norms. Four number CAAQMS Station installed as per guidelines and connected to RSPCB and CPCB servers for online monitoring. Most of time Plant is under shutdown due to power management. Ambient Air Quality Monitoring Reports from NABL approved laboratory are attached as Annexure -1
15.	The project proponent shall advertise in at least two local newspaper widely circulated in the region around the project, one of which shall be in the vernacular language of the locality concerned within seven days of issue of this letter, informing that the project has been accorded environmental clearance and copies of clearance letter are available with the State Pollution Control Board/Committee and may also seen at Website of the Ministry of Environment & Forest at http://enfor.nic.in	Grant of Environmental Clearance has advertised in Rajasthan Patrika & Dainik Bhasker on dated 03.01.2008. copy already provided to your good office.
16.	A separate environment management cell with qualified staff shall be set up for implementation of the stipulated environmental safeguards.	Environment Dept. has been setup for environmental management. Unit Head to look after about the total control of pollution, monitoring & maintenance of pollution control devices with the help of Site Manager along with Environment Dept. Officers, Engineer (Chemical) & trained team.
17.	Half yearly report on the status of implementation of the stipulated conditions and environmental safeguard shall be submitted to this Ministry, the Regional Office, and the CPCB / SPCB.	Complete half yearly report is submitted to all concerned departments within time frame as directed.
18.	Regional Office of the Ministry of Environmental & Forests located at Lucknow will monitor the implementation of the stipulated conditions. A complete set of documents submitted to this ministry shall be forwarded to the Regional Office for their use during monitoring.	The complete set of documents is forwarded to concerned departments.
19.	Separate funds shall be allocated for implementation of environmental protection measures along with item-wise break-up. These costs shall be include as part of the project cost. The funds earmarked for the environment protection measures shall not be diverted for other purpose and year-wise expenditure shall be reported to the Ministry.	The total cost of project is 43 crore apx. out of which Rs. 339 Lacs invested for Env. Protection measures & Rs. 29 Lacs kept for recurring expenditure on environmental protection (During plant erection & commissioning).



20.	Full cooperation shall be extends to the Scientist/Officers from the Ministry / Regional Office of the Ministry at Lucknow / the CPCB / the SPCB who would be monitoring the compliance of environmental status.	Agreed
-----	--	--------

Remark: Plant is under shutdown from Jul-23 to till date. The information has already been communicated to the board.

Occupational health surveillance report (Medical Checkup) attached. Annexure-3.

We hope you will find the document in order.

Thanking you,

Yours faithfully

For J K White Cement Works (Unit of J K Cement Ltd.)



Dr. Ranjeet Kumar Bagariya
(Environment Head)
Authorized Signatory

CC To:

Reg. A/d: Member Secretary,

Rajasthan State Pollution Control Board
4, Institutional Area, Jhalana Doongari, Jaipur (Raj.) - 302 004

Reg. A/d: Regional Officer (Regional Office),

Rajasthan State Pollution Control Board,
First Floor, Sehkari Bhoomi Vikas Bank Ltd., Nagaur- 341001



TEST REPORT



Sample Number: VTL/AA/01-04
Name & Address of the Party M/s JK White Cement Works
 (Unit of JK Cement Ltd.) Vill. & Po.- Gotan,
 Dist.-Nagaur, Rajasthan

Report No.: VTL/A/2409140017-20/A
Format No.: 7.8 F 02
Party Reference No.: NIL
Report Date: 24/09/2024
Period of Analysis: 14-24/09/2024
Receipt Date 14/09/2024

Sample Description : Ambient Air Quality Monitoring

General Information:-
Sample collected by : VTL Team
Instrument Calibration Status : Calibrated
Meteorological condition during monitoring : Clear sky
Date of Sampling : 10/09/2024 to 11/09/2024
Ambient Temperature (°C) : Min. 26°C, Max. 35 °C
Surrounding Activity : Human , Vehicular & Plant Activities
Scope of Monitoring : Regulatory Requirement
Sampling & Analysis Protocol : IS-5182 & CPCB Guidelines
Sampling Duration : 24 hrs.
Parameter Required : As Per Work Order

Sr.	Parameter	Protocol	Location & Lat. Long				Unit	NAAQS 2009
			132 KVSS	Rest Shelter /Doolomite Ramp	EDP Club Building	CS-11		
			73°44'46"E 26°38'50"N	73°44'32"E 26°38'43"N	73°44'33"E 26°38'30"N	73°44'46"E 26°38'28"N		
1.	Particulate Matter (PM10)	IS: 5182 (P-23), 2006, RA 2017	60.20	62.44	54.61	59.37	µg/m ³	100
2.	Particulate Matter (PM2.5)	IS 5182 (P-24) -2019	30.25	32.29	26.52	28.79	µg/m ³	60
3.	Sulphur Dioxide (SO2)	IS: 5182 (P-2), 2001, RA 2018	7.54	9.21	6.25	7.63	µg/m ³	80
4.	Nitrogen Dioxide (NO2)	IS: 5182 (P-6), 2006 RA 2018	15.34	17.48	12.62	14.15	µg/m ³	80
5.	Benzene (as C6H6)	IS: 5182 (P-11)-2006, RA.2017	*BLQ(**LOQ1.0)	*BLQ(**LOQ1.0)	*BLQ(**LOQ1.0)	*BLQ(**LOQ1.0)	µg/m ³	5
6.	Ammonia (as NH3)	3 rd Ed. 1988, Method No. 401	6.25	7.85	6.08	6.98	µg/m ³	400
7.	Ozone (as O3)	IS:5182 (P-9):1974, RA.2019	10.51	12.37	9.78	10.62	µg/m ³	180
8.	Lead (as pb)	IS:5182 (P-22):2004, RA.2019	*BLQ(**LOQ0.02)	*BLQ(**LOQ0.02)	*BLQ(**LOQ0.02)	*BLQ(**LOQ0.02)	µg/m ³	1
9.	Arsenic (as As)	3 rd Ed. 1988, Method No. 302	*BLQ(**LOQ0.15)	*BLQ(**LOQ0.15)	*BLQ(**LOQ0.15)	*BLQ(**LOQ0.15)	ng/m ³	6
10.	Nickel (as Ni)	USEPA Compendlum 10-3.2, 1999	*BLQ(**LOQ5.0)	*BLQ(**LOQ5.0)	*BLQ(**LOQ5.0)	*BLQ(**LOQ5.0)	ng/m ³	20
11.	Benzo (a) Pyrene	IS:5182 (P-12):2004, RA.2019	*BLQ(**LOQ0.2)	*BLQ(**LOQ0.2)	*BLQ(**LOQ0.2)	*BLQ(**LOQ0.2)	ng/m ³	1

*****End of the Report*****

Checked By



RK Yadav
 Lab Incharge
 Authorized Signatory

Term & conditions PTO

Approved & Certified EPA 1986 Recognised, ISO:9001 and OHSAS:45001 Certified

Vibrant Techno Lab Pvt. Ltd.

SC-40, 3rd Floor, Narayan Vihar S, Ajmer Road, Jaipur Raj. 302020
 9929108691, 9810205356, 8005707098, 9549956601

0141-2954638
 bd@vibranttechnolab.com
 www.vibranttechnolab.com



TEST REPORT

VIBRANT
"Experience the unimaginable"

Sample Number: VTL/AA/01-04 Report No.: VTL/A/2409140017-20/B
 Name & Address of the Party: M/s JK White Cement Works (Unit of JK Cement Ltd.) Vill. & Po.- Gotan, Dist.-Nagaur, Rajasthan Format No.: 7.8 F 02
 Party Reference No.: NIL
 Sample Description: Ambient Air Quality Monitoring Report Date: 24/09/2024
 Period of Analysis: 14-24/09/2024
 Receipt Date: 14/09/2024

General Information:-
 Sample collected by : VTL Team
 Instrument Calibration Status : Calibrated
 Meteorological condition during monitoring : Clear sky
 Date of Sampling : 10/09/2024 to 11/09/2024
 Ambient Temperature (°C) : Min. 26°C, Max. 35 °C
 Surrounding Activity : Human , Vehicular & Plant Activities
 Scope of Monitoring : Regulatory Requirement
 Sampling & Analysis Protocol : IS-5182 & CPCB Guidelines
 Sampling Duration : 24 hrs.
 Parameter Required : As Per Work Order

Sr.	Parameter	Protocol	Location & Lat. Long				Unit	NAAQS 2009
			132 KVSS	Rest Shelter /Doolomite Ramp	EDP Club Building	CS-11		
			73°44'46"E 26°38'50"N	73°44'32"E 26°38'43"N	73°44'33"E 26°38'30"N	73°44'46"E 26°38'28"N		
1.	Carbon Monoxide (as CO)	IS:5182 (P-10) NDIR	0.46	0.51	0.58	0.42	mg/m ³	4

-----End of the Report-----

VIBRANT
"Experience the unimaginable"

Checked By



RK Yadav
Lab Incharge
Authorized Signatory

Term & conditions PTO

Approved & Certified EPA 1986 Recognised, ISO:9001 and OHSAS:45001 Certified

Vibrant Techno Lab Pvt. Ltd.

SC-40, 3rd Floor, Narayan Vihar S, Ajmer Road, Jaipur Raj. 302020

9929108691, 9810205356, 8005707098, 9549956601

0141-2954638

bd@vibranttechnolab.com

www.vibranttechnolab.com



TEST REPORT



TC-11227

Sample Number:	VTL/AN/01-04	Report No.:	VTL/N/2409140017-20/A
Name & Address of the Party:	M/s JK White Cement Works (Unit of JK Cement Ltd.) Vill. & Po.- Gotan, Dist.-Nagaur, Rajasthan	Format No.:	7.8 F 04
Sample Description:	Ambient Noise Level Monitoring	Party Reference No.:	NIL
Scope of Monitoring:	Regulatory Requirement	Report Date:	24/09/2024
Protocol Used:	IS 9989	Receipt Date:	14/09/2024
Instrument Used:	SLM	Sampling Duration:	24 Hrs.
		Sample Collected by:	VTL Team
		Instrument Calibration Status:	Calibrated

Ambient Noise Level Monitoring Results

General Information:-

Meteorological condition during monitoring	: Clear sky
Date of Monitoring	: 10/09/2024 to 11/09/2024
Time of Monitoring	: 06:00 AM to 06:00AM
Ambient Temperature (°C)	: Min. 26°C, Max. 35 °C
Surrounding Activity	: Human, Vehicular & Plant Activities
Parameter Required	: As per Work Order

Sr.	Test Parameter	Protocol	Location & Latlong							
			132 KVSS		Rest Shelter /Doolomite Ramp		EDP Club Building		CS-11	
			73°44'46"E 26°38'50"N		73°44'32"E 26°38'43"N		73°44'33"E 26°38'30"N		73°44'46"E 26°38'28"N	
1.	L _{eq} , dB(A)	IS:9989-1981, RA 2020	Day Time	Night Time	Day Time	Night Time	Day Time	Night Time	Day Time	Night Time
			61.8	47.5	63.6	40.2	57.3	42.1	55.9	43.2

Category of Zones	Leq in dB (A)	
	Day	Night
Industrial	75	70
Commercial	65	55
Residential	55	45
Silence Zone	50	40

1. Day Time is from 6.00 AM to 10.00 PM.
 2. Night Time is reckoned between 10.00 PM to 6.00 AM.
 3. Silence Zone is defined as an area up to 100 m around premises of Hospitals, Educational and Courts. Use of vehicle horn, Loudspeakers and bursting of crackers is banned in these zones.
 Note: Mixed categories of areas be declared as one of the four above mentioned categories by the competent Authority and the corresponding standards shall apply

-----End of the Report-----

Checked By



RK Yadav
 Lab Incharge
 Authorized Signatory

Term & conditions: PTO

Approved & Certified

 EPA 1986 Recognised, ISO:9001 and OHSAS:45001 Certified

Vibrant Techno Lab Pvt. Ltd.

SC-40, 3rd Floor, Narayan Vihar S, Ajmer Road, Jaipur Raj. 302020
 9929108691, 9810205356, 8005707098, 9549956601

0141-2954638
 bd@vibranttechnolab.com
 www.vibranttechnolab.com



TEST REPORT



Sample Number: **VTL/AA/01-04**
 Name & Address of the Party: **M/s JK White Cement Works (Unit of JK Cement Ltd.) VIII & Po.- Gotan, Dist.-Nagaur, Rajasthan**

Report No.: **VTL/A/2406150005-08/A**
 Format No.: **7.0 F 02**
 Party Reference No.: **NIL**
 Report Date: **20/06/2024**
 Period of Analysis: **15-20/06/2024**
 Receipt Date: **15/06/2024**

Sample Description : **Ambient Air Quality Monitoring**

General Information:-
 Sample collected by : **VTL Team**
 Instrument Calibration Status : **Calibrated**
 Meteorological condition during monitoring : **Clear sky**
 Date of Sampling : **12/06/2024 to 13/06/2024**
 Ambient Temperature (°C) : **Min. 33°C, Max. 42 °C**
 Surrounding Activity : **Human , Vehicular & Plant Activities**
 Scope of Monitoring : **Regulatory Requirement**
 Sampling & Analysis Protocol : **IS-5182 & CPCB Guidelines**
 Sampling Duration : **24 hrs.**
 Parameter Required : **As Per Work Order**

Sr.	Parameter	Protocol	Location & Lat-Long				Unit	NAAQS 2009
			132-KVSS	Rest Shelter /Doolomite Ramp	EDP Club Building	CS-11		
			73°44'46"E 26°38'50"N	73°44'32"E 26°38'43"N	73°44'33"E 26°38'30"N	73°44'46"E 26°38'28"N		
1.	Particulate Matter (PM10)	IS: 5182 (P-23), 2006, RA 2017	65.42	68.25	57.69	66.75	µg/m ³	100
2.	Particulate Matter (PM2.5)	IS 5182 (P-24) -2019	33.21	35.73	28.46	34.62	µg/m ³	60
3.	Sulphur Dioxide (SO2)	IS: 5182 (P-2), 2001, RA 2018	0.67	10.54	7.44	9.59	µg/m ³	80
4.	Nitrogen Dioxide (NO2)	IS: 5182 (P-6), 2006 RA 2018	17.80	19.57	13.76	18.41	µg/m ³	80
5.	Benzene (as C6H6)	IS: 5182 (P-11)-2006, RA.2017	*BLQ(**LOQ1.0)	*BLQ(**LOQ1.0)	*BLQ(**LOQ1.0)	*BLQ(**LOQ1.0)	µg/m ³	5
6.	Ammonia (as NH3)	3 rd Ed. 1988, Method No. 401	7.32	9.11	7.10	78.32	µg/m ³	400
7.	Ozone (as O3)	IS:5182 (P-9):1974, RA.2019	12.56	15.70	10.84	14.51	µg/m ³	180
8.	Lead (as pb)	IS:5182 (P-22):2004, RA.2019	*BLQ(**LOQ0.02)	*BLQ(**LOQ0.02)	*BLQ(**LOQ0.02)	*BLQ(**LOQ0.02)	µg/m ³	1
9.	Arsenic (as As)	3 rd Ed. 1988, Method No. 302	*BLQ(**LOQ0.15)	*BLQ(**LOQ0.15)	*BLQ(**LOQ0.15)	*BLQ(**LOQ0.15)	ng/m ³	6
10.	Nickel (as Ni)	USEPA Compendium IO-3.2, 1999	*BLQ(**LOQ5.0)	*BLQ(**LOQ5.0)	*BLQ(**LOQ5.0)	*BLQ(**LOQ5.0)	ng/m ³	20
11.	Benzo (a) Pyrene	IS:5182 (P-12):2004, RA.2019	*BLQ(**LOQ0.2)	*BLQ(**LOQ0.2)	*BLQ(**LOQ0.2)	*BLQ(**LOQ0.2)	ng/m ³	1

End of the Report-----



RK Yadav
 Lab Incharge
 Authorized Signatory

Term & Conditions FTG



EPA 1986 Recognised, ISO:9001 and OHSAS:45001 Certified

Vibrant Techno Lab Pvt. Ltd.

SC-40, 3rd Floor, Narayan Vihar S, Ajmer Road, Jaipur Raj. 302020
 9929108691, 9810205356, 8005707098, 9549956601

☎ 0141-2954638
 ✉ bd@vibranttechnolab.com
 🌐 www.vibranttechnolab.com





TEST REPORT

Sample Number: VTL/AA/01-04
 Name & Address of the Party: M/s JK White Cement Works (Unit of JK Cement Ltd.) Vill. & Po. Gotan, Dist. Nagaur, Rajasthan
 Sample Description: Ambient Air Quality Monitoring

Report No.: VTL/A/2406150005-00/B
 Format No.: 7.8 F 02
 Party Reference No.: NIL
 Report Date: 20/06/2024
 Period of Analysis: 15-20/06/2024
 Receipt Date: 15/06/2024

General Information:-
 Sample collected by : VTL Team
 Instrument Calibration Status : Calibrated
 Meteorological condition during monitoring : Clear sky
 Date of Sampling : 12/06/2024 to 13/06/2024
 Ambient Temperature (°C) : Min. 33°C, Max. 42 °C
 Surrounding Activity : Human, Vehicular & Plant Activities
 Scope of Monitoring : Regulatory Requirement
 Sampling & Analysis Protocol : IS-5182 & CPCB Guidelines
 Sampling Duration : 24 hrs.
 Parameter Required : As Per Work Order

Sr.	Parameter	Protocol	Location & Lat. Long				Unit	NAAQS 2009
			132 KVSS	Rest Shelter /Doolomite Ramp	EDP Club Building	CS-11		
1.	Carbon Monoxide (as CO)	IS:5182 (P-10) NDIR	73°44'46"E 26°38'30"N	73°44'32"E 26°38'43"N	73°44'33"E 26°38'30"N	73°44'46"E 26°38'28"N	mg/m ³	4

End of the Report



RK Yadav
 Lab Incharge
 Authorized Signatory

Term & condition PTO

Checked By
 Approved & Certified

EPA 1986 Recognised, ISO:9001 and OHSAS:45001 Certified

Vibrant Techno Lab Pvt. Ltd.

◇ SC-40, 3rd Floor, Narayan Vihar S, Ajmer Road, Jaipur Raj. 302020
 □ 9929108691, 9810205356, 8005707098, 9549956601



☎ 0141-2954638
 ✉ bd@vibranttechnolab.com
 🌐 www.vibranttechnolab.com



TEST REPORT



Sample Number: VTL/AN/01-04
 Name & Address of the Party: M/s JK White Cement Works
 (Unit of JK Cement Ltd.) Vill. & Po.- Gotan,
 Dist.-Nagaur, Rajasthan
 Sample Description: Ambient Noise Level Monitoring
 Scope of Monitoring: Regulatory Requirement
 Protocol Used: IS 9989
 Instrument Used: SLM

Report No.: VTL/N/2406150005-08/A
 Format No.: 7.8 F 04
 Party Reference No.: NIL
 Report Date: 20/06/2024
 Receipt Date: 15/06/2024
 Sampling Duration: 24 Hrs.
 Sample Collected by: VTL Team
 Instrument Calibration Status: Calibrated

Ambient Noise Level Monitoring Results

General Information:-

Meteorological condition during monitoring : Clear sky
 Date of Monitoring : 12/06/2024 to 13/06/2024
 Time of Monitoring : 06:00 AM to 06:00 AM
 Ambient Temperature (°C) : Min. 33°C, Max. 42 °C
 Surrounding Activity : Human, Vehicular & Plant Activities
 Parameter Required : As per Work Order

Sr.	Test Parameter	Protocol	Location & Latlong							
			132 RVSS		Rest Shelter / Doolomite Ramp		RDP Club Building		CS-11	
			73°44'46"E 26°38'50"N	73°44'32"E 26°38'43"N	73°44'33"E 26°38'30"N	73°44'46"E 26°38'28"N	Day Time	Night Time	Day Time	Night Time
I.	L _{eq} dB(A)	IS:9989-1981, RA 2020	63.3	48.7	65.2	42.1	60.8	44.3	56.9	46.5

Category of Zones	Leq in dB (A)	
	Day	Night
Industrial	75	70
Commercial	65	55
Residential	55	45
Silence Zone	50	40

1. Day Time is from 6.00 AM to 10.00 PM.
 2. Night Time is reckoned between 10.00 PM to 6.00 AM.
 3. Silence Zone is defined as an area up to 100 m around premises of Hospitals, Educational and Courts. Use of vehicle horn, Loudspeakers and bursting of crackers is banned in these zones.
 Note: Mixed categories of areas be declared as one of the four above mentioned categories by the competent Authority and the corresponding standards shall apply.

-----End of the Report-----

Checked By



RK Yadav
 Lab Incharge
 Authorized Signatory

Term & conditions PFO

Approved & Certified EPA 1986 Recognised, ISO:9001 and ISO:14001:2015 Certified

Vibrant Techno Lab Pvt. Ltd.

SC-40, 3rd Floor, Narayan Vihar S, Ajmer Road, Jaipur Raj. 302020
 9929108691, 9810205356, 8005707098, 9549956601

0141-2954633
 bd@vibranttechnolab.com
 www.vibranttechnolab.com



AMBIENT AIR QUALITY MONITORING REPORT

MONTH: JUL-2024

SR.	DATE	LOCATION	PM ₁₀ µg/M ³	PM _{2.5} µg/M ³	SO ₂ µg/M ³	NOx µg/M ³	CO µg/M ³
1	03.07.2024	132 KV SS	60	39	11.0	13.0	1282
2	30.07.2024	132 KV SS	52	30	12.0	14.0	1304
3	03.07.2024	Rest Shelter	53	34	13.0	12.0	1316
4	30.07.2024	Rest Shelter	55	31	14.0	15.0	1144
5	03.07.2024	EDP	49	30	13.0	16.0	1316
6	30.07.2024	EDP	56	30	15.0	13.0	1270
7	03.07.2024	CS-11	48	35	11.0	13.0	1247
8	30.07.2024	CS-11	53	27	10.0	12.0	1190

AMBIENT AIR QUALITY MONITORING REPORT

MONTH: AUG-2024

SR.	DATE	LOCATION	PM ₁₀ µg/M ³	PM _{2.5} µg/M ³	SO ₂ µg/M ³	NOx µg/M ³	CO µg/M ³
1	02.08.2024	132 KV SS	51.09	30.17	13	14	1293
2	30.08.2024	132 KV SS	49.14	34.57	12	12	1282
3	02.08.2024	Rest Shelter	46.48	30.42	14	15	1304
4	30.08.2024	Rest Shelter	42.03	31.63	13	14	1282
5	02.08.2024	EDP	46.57	30.21	15	15	1270
6	30.08.2024	EDP	46.30	31.33	11	16	1293
7	02.08.2024	CS-11	47.54	35.67	13	13	1316
8	30.08.2024	CS-11	43.72	31.17	12	14	1304

AMBIENT AIR QUALITY MONITORING REPORT

MONTH: SEP-2024

SR.	DATE	LOCATION	PM ₁₀ µg/M ³	PM _{2.5} µg/M ³	SO ₂ µg/M ³	NOx µg/M ³	CO µg/M ³
1	02.09.2024	132 KV SS	50.82	31.60	13.0	15.0	1293
2	29.09.2024	132 KV SS	48.52	35.67	11.0	16.0	1304
3	02.09.2024	Rest Shelter	47.89	34.60	12.0	15.0	1327
4	29.09.2024	Rest Shelter	46.85	31.08	13.0	17.0	1316
5	02.09.2024	EDP	43.35	30.20	14.0	18.0	1293
6	29.09.2024	EDP	48.08	40.25	12.0	17.0	1282
7	02.09.2024	CS-11	45.00	31.19	14.0	16.0	1362
8	29.09.2024	CS-11	47.83	30.42	12.0	18.0	1339



JK WHITE CEMENT WORKS, GOTAN
MONTHLY ENVIRONMENT MONITORING REPORT
FOR THE QUARTER -2 (JUL-2024 TO SEP-2024) FY 2024-25

STACK MONITORING REPORT MONTH: JUL-2024											
S. No	Stack Mark	Stack attached to	Stack DIA (in mm)	Stack Height. From G.L. (mtrs.)	Operating conditions	Temp. of Gases °C	Velocity (m/sec)	Volume of Gas in Stack (Nm3/ Min)	PM (Mg/Nm3)	SO ₂ (mg/Nm ³)	NO _x (mg/Nm ³)
1	P	Boiler Stack (TPP)	1200	72	Normal operating conditions						
PLANT UNDER SHUTDOWN											

STACK MONITORING REPORT MONTH: AUG-2024											
S. No	Stack Mark	Stack attached to	Stack DIA (in mm)	Stack Height. From G.L. (mtrs.)	Operating conditions	Temp. of Gases °C	Velocity (m/sec)	Volume of Gas in Stack (Nm3/ Min)	PM (Mg/Nm3)	SO ₂ (mg/Nm ³)	NO _x (mg/Nm ³)
1	P	Boiler Stack (TPP)	1200	72	Normal operating conditions						
PLANT UNDER SHUTDOWN											

STACK MONITORING REPORT MONTH: SEP-2024											
S. No	Stack Mark	Stack attached to	Stack DIA (in mm)	Stack Height. From G.L. (mtrs.)	Operating conditions	Temp. of Gases °C	Velocity (m/sec)	Volume of Gas in Stack (Nm3/ Min)	PM (Mg/Nm3)	SO ₂ (mg/Nm ³)	NO _x (mg/Nm ³)
1	P	Boiler Stack (TPP)	1200	72	Normal operating conditions						
PLANT UNDER SHUTDOWN											

Plant Under Shutdown from 23 July 2023 to till now Heeslar Stack Hourly not App.



Ambient Noise Level Measurement Record (in dB (A))
at Thermal Power Plant Site

Date: 28/9/24

Time: 1:00 PM

Day/ Night: Day Night

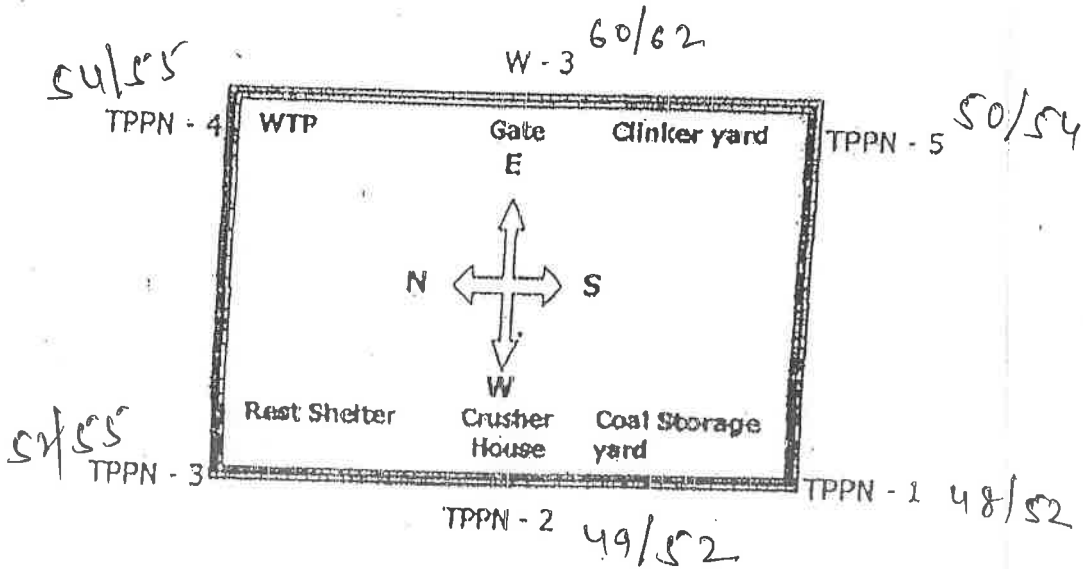

- Crusher : Operating / Not Operating
- Boiler : Operating / Not Operating
- Air Cooled Condenser : Operating / Not Operating
- WTP : Operating / Not Operating
- Air Compressor : Operating / Not Operating

REMARKS IF ANY:

Measured by:

Leg 49/50

Dr. R. K. Bagariya

**Ambient Noise Level Measurement Record (in dB (A))
at Thermal Power Plant Site**

Date: 28.9.24

Time: 10:45 PM

Day/ Night: Day

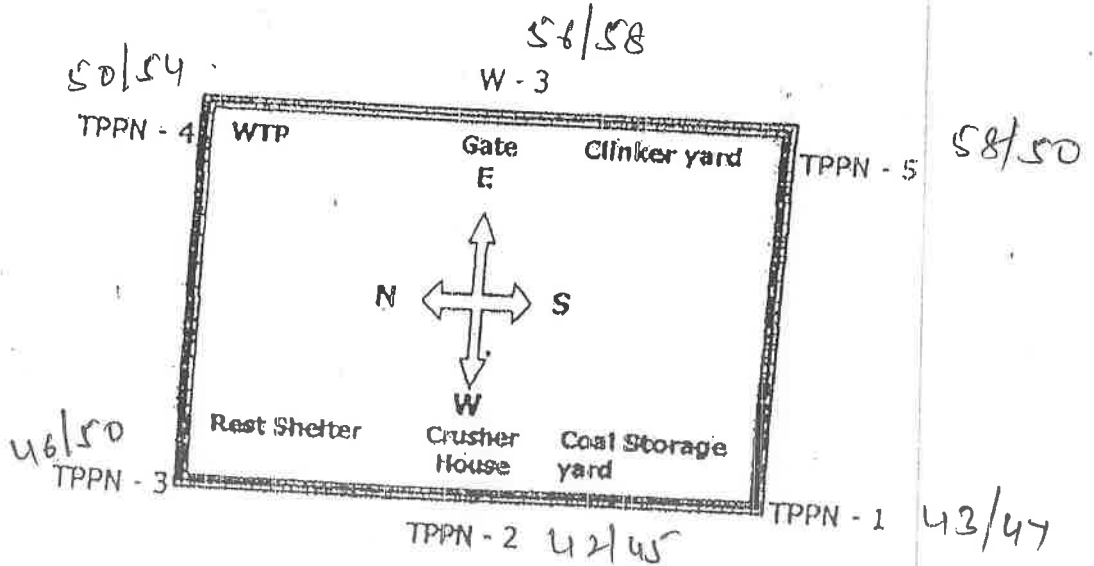

- Crusher : Operating / Not Operating
- Boiler : Operating / Not Operating
- Air Cooled Condenser : Operating / Not Operating
- WTP : Operating / Not Operating
- Air Compressor : Operating / Not Operating

REMARKS IF ANY:

Measured by: Leg 44:50



Ambient Noise Level Measurement Record (in dB (A))
at Thermal Power Plant Site

Date: 24/8/24

Time: 11:30 PM

Day/ Night: Night

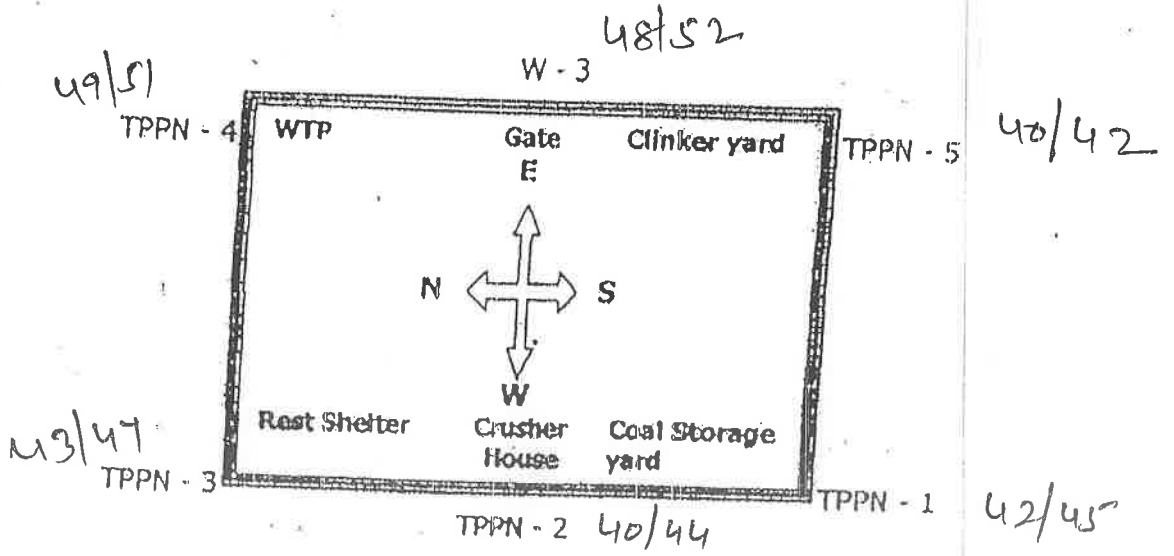

- Crusher : Operating / Not Operating
- Boiler : Operating / Not Operating
- Air Cooled Condenser : Operating / Not Operating
- WTP : Operating / Not Operating
- Air Compressor : Operating / Not Operating

REMARKS IF ANY:

Measured by: Leg 42.30



Ambient Noise Level Measurement Record (in dB (A))
at Thermal Power Plant Site

Date: 27/07/24

Time: 10.00

Day/ Night: Day Night

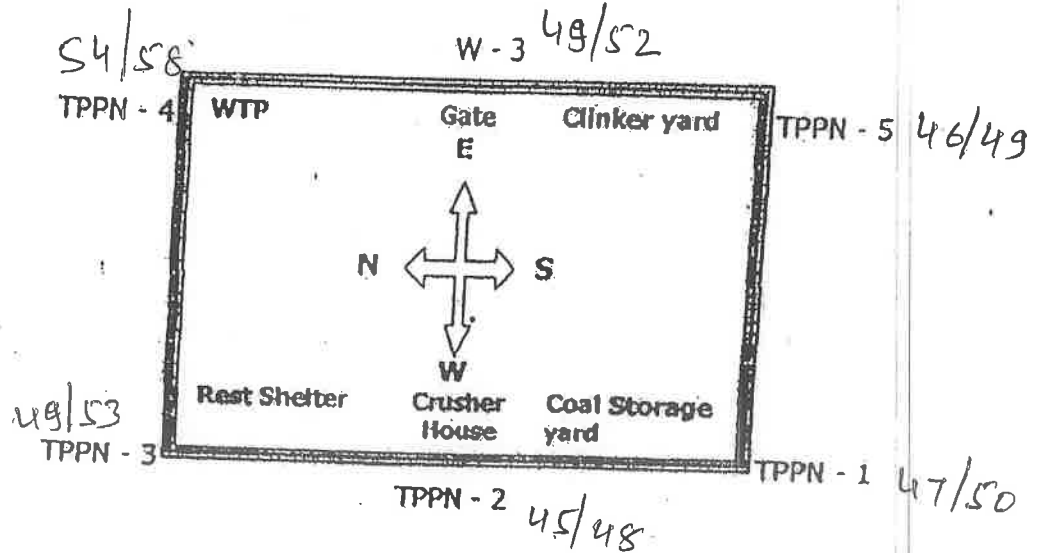

- Crusher : Operating / Not Operating
- Boiler : Operating / Not Operating
- Air Cooled Condenser : Operating / Not Operating
- WTP : Operating / Not Operating
- Air Compressor : Operating / Not Operating

REMARKS IF ANY:

Measured by: Geeg. 42.0



 Dr. K.K. Bagariya

Ambient Noise Level Measurement Record (in dB (A))
at Thermal Power Plant Site

Date: 27/7/24

Time: 10.25

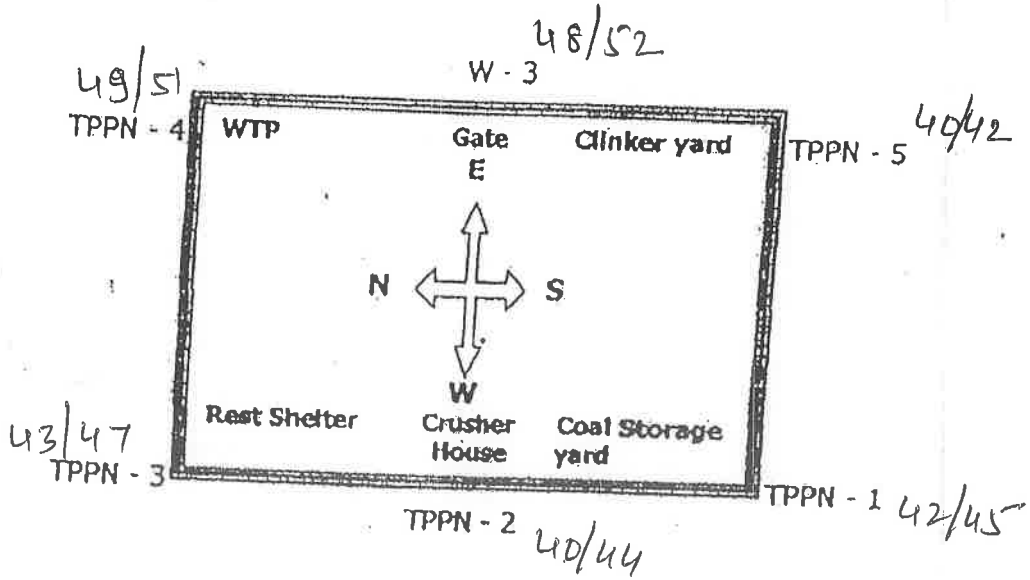
Day/ Night: Day



- Crusher : Operating / Not Operating
- Boiler : Operating / Not Operating
- Air Cooled Condenser : Operating / Not Operating
- WTP : Operating / Not Operating
- Air Compressor : Operating / Not Operating

REMARKS IF ANY:

Measured by: 609 - 42.09



Dr. R.R. Bagariya

Ambient Noise Level Measurement Record (in dB (A))
at Thermal Power Plant Site

Date: 29/06/2024

Time: 9:40

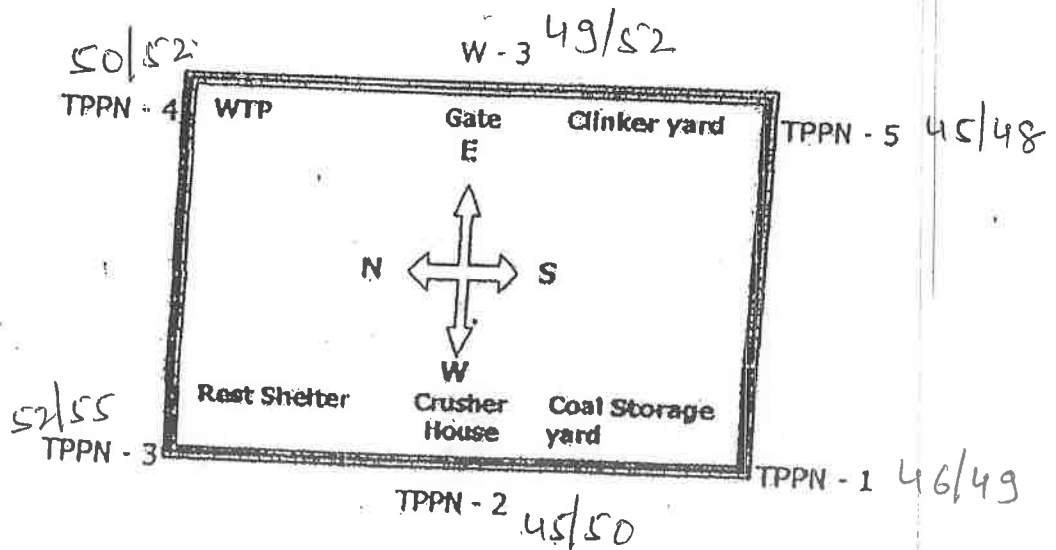
Day/ Night: Day



- Crusher : Operating / Not Operating
- Boller : Operating / Not Operating
- Air Cooled Condenser : Operating / Not Operating
- WTP : Operating / Not Operating
- Air Compressor : Operating / Not Operating

REMARKS IF ANY:

Measured by: Gay. 48.17



Ambient Noise Level Measurement Record (in dB (A))
at Thermal Power Plant Site

Date: 25/05/2024

Time: 10.00

Day/ Night:

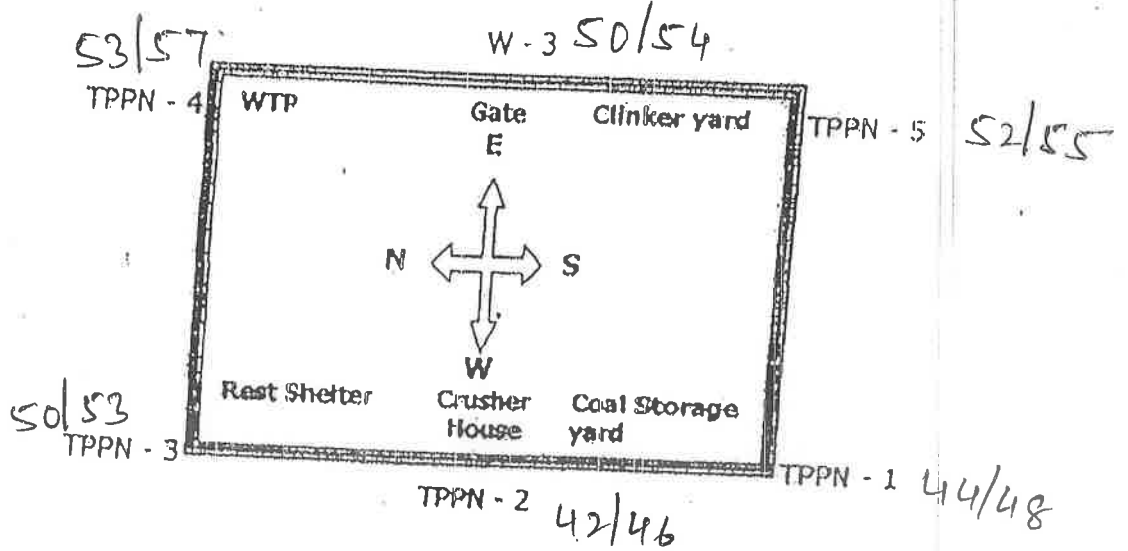

- Crusher : Operating / Not ~~Operating~~
- Boiler : Operating / Not ~~Operating~~
- Air Cooled Condenser : Operating / Not ~~Operating~~
- WTP : Operating / Not ~~Operating~~
- Air Compressor : Operating / Not ~~Operating~~

REMARKS IF ANY:

Measured by: Leq. 49.10

Dr. R. R. Bagariya

Ambient Noise Level Measurement Record (in dB (A))
at Thermal Power Plant Site

Date: 25/05/2024

Time: 10:25

Day/ Night:

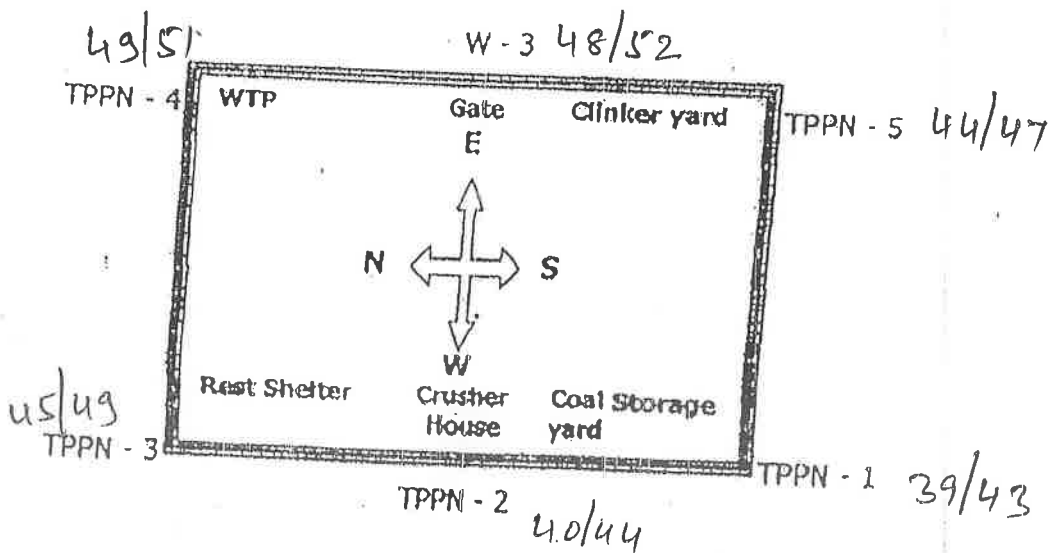

- Crusher : Operating / Not Operating ✓
- Boiler : Operating / Not Operating ✓
- Air Cooled Condenser : Operating / Not Operating ✓
- WTP : Operating / Not Operating ✓
- Air Compressor : Operating / Not Operating ✓

REMARKS IF ANY:

Measured by: Yeg - 41.16



Dr. K.K. Bagariya

Ambient Noise Level Measurement Record (in dB (A))
at Thermal Power Plant Site

Date: 27/04/2024

Time: 9.40

Day/ Night: Day

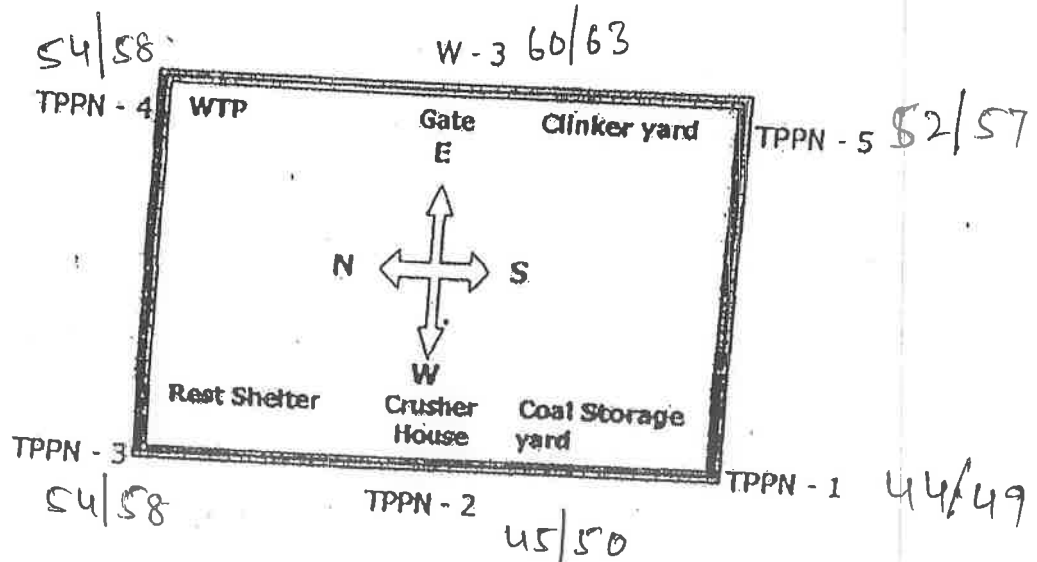

- Crusher : Operating / Not Operating
- Boller : Operating / Not Operating
- Air Cooled Condenser : Operating / Not Operating
- WTP : Operating / Not Operating
- Air Compressor : Operating / Not Operating

REMARKS IF ANY:

Measured by: Deq. 49.10



Ambient Noise Level Measurement Record (in dB (A))
at Thermal Power Plant Site

Date: 27/04/2024

Time: 10.00

Day/ Night: Day

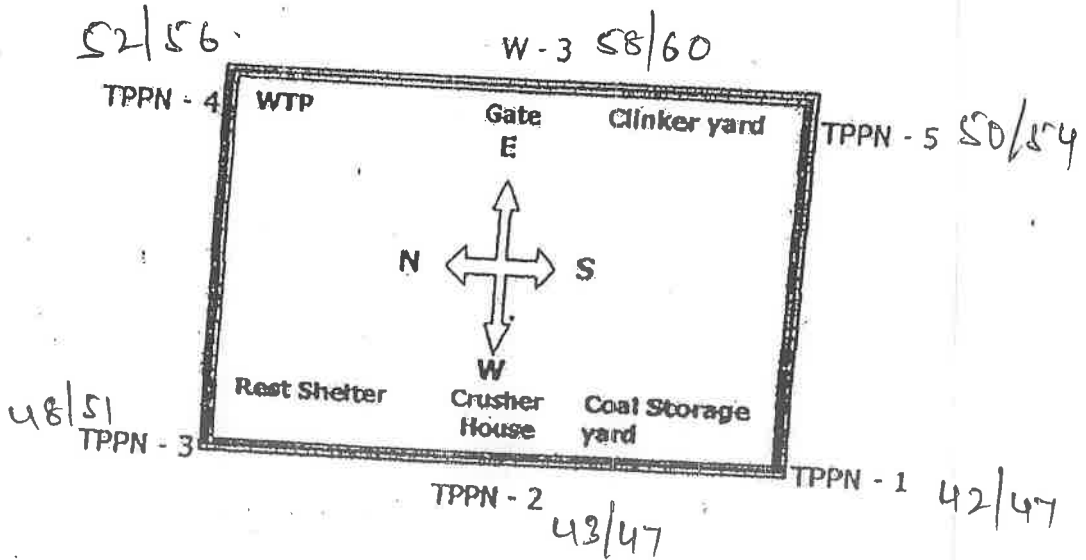

- Crusher : Operating / ~~Not Operating~~
- Boiler : Operating / ~~Not Operating~~
- Air Cooled Condenser : Operating / ~~Not Operating~~
- WTP : Operating / ~~Not Operating~~
- Air Compressor : Operating / ~~Not Operating~~

REMARKS IF ANY:

Measured by:

Log. 56.14



 Dr. R. K. Bagariya

ANNEXURE

DRAWN	MRADHYA S.	TITLE	J.K. WHITE CEMENT WORKS, GOTAN
DATE	10-08-14	PROJECT	Thermal Power Plant
CHECKED	S. MISHRA	SCALE	1:500
APPROVED		REV. NO.	LO-64
		REV. DATE	
		DESCRIPTION	
		DRN.	
		CHD.	

NOTES-
 1. ALL DIMENSIONS ARE IN METERS UNLESS OTHERWISE SPECIFIED.
 2. DONOT SCALE THE DIMENSIONS. IN CASE OF DOUBT, PLEASE ASK.

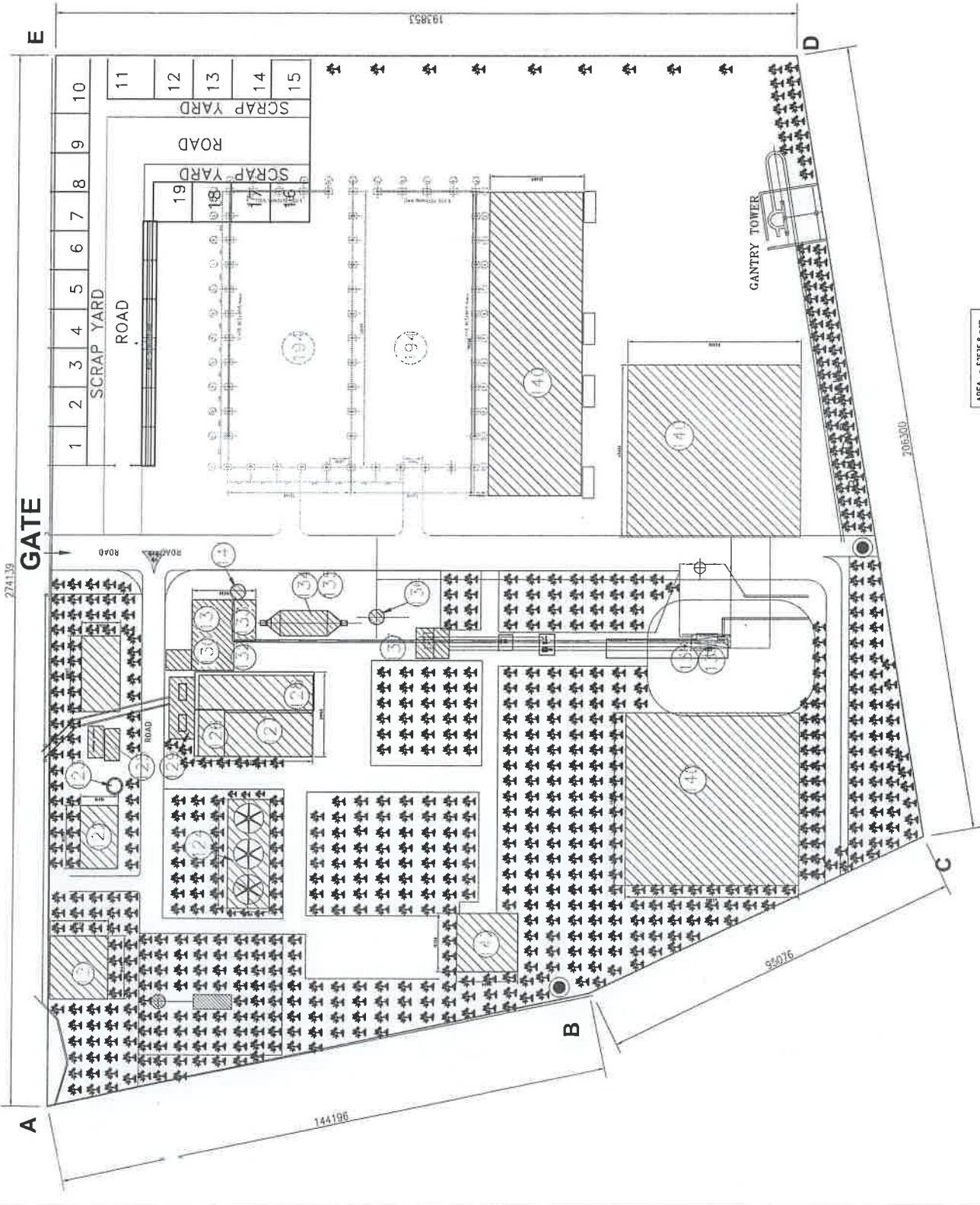
S.NO.	INDEX
194.	PETRO COKE COVERED SHED
142.	TPP OFFICE
141.	ASH SILO(TPP)
140.	FUEL STORAGE YARD(TPP)
139.	GREZZALY HOPPER(TPP)
138.	CRUISHER HOUSE(TPP)
137.	CONVEYOR(TPP)
136.	CHIMNEY (TPP)
135.	ID FAN(TPP)
134.	ESP(TPP)
133.	FD FAN(TPP)
132.	PA FAN(TPP)
131.	BUNKER(TPP)
130.	BOILER(TPP)
129.	TRANSFORMER YARD(TPP)
128.	DEAERATOR CUM STORAGE TANK(TPP)
127.	CONTROL ROOM(TPP)
126.	TG HOUSE(TPP)
125.	AUXILIARY TOWER (TPP)
124.	AIR COOLED CONDENSOR (TPP)
123.	DM STORAGE TANK (TPP)
122.	WATER TREATMENT PLANT (TPP)
121.	RAW WATER STORAGE TANK (TPP)



AREA = 52535.8 sqm
 = 565285.0 sqft
 = 32.4 Bigha
 = 5.25 Hect
 = 12.97 Acres

EXISTING PLANT



Plantation Photographs

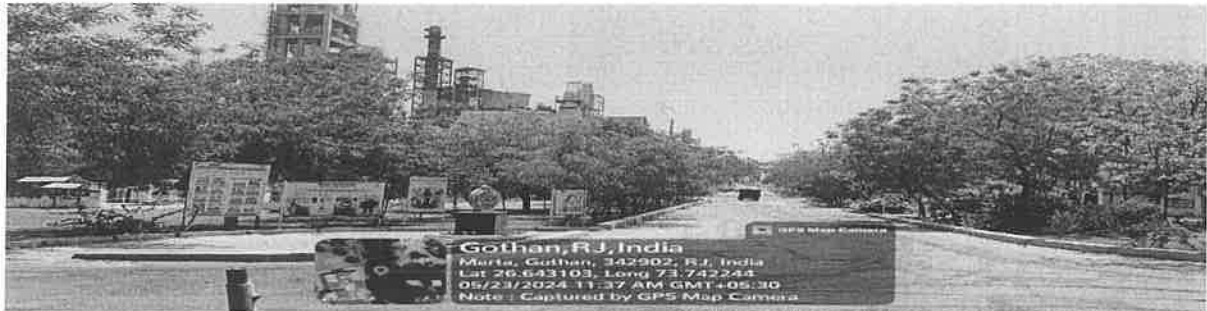

Gate Display Boards: JKWC

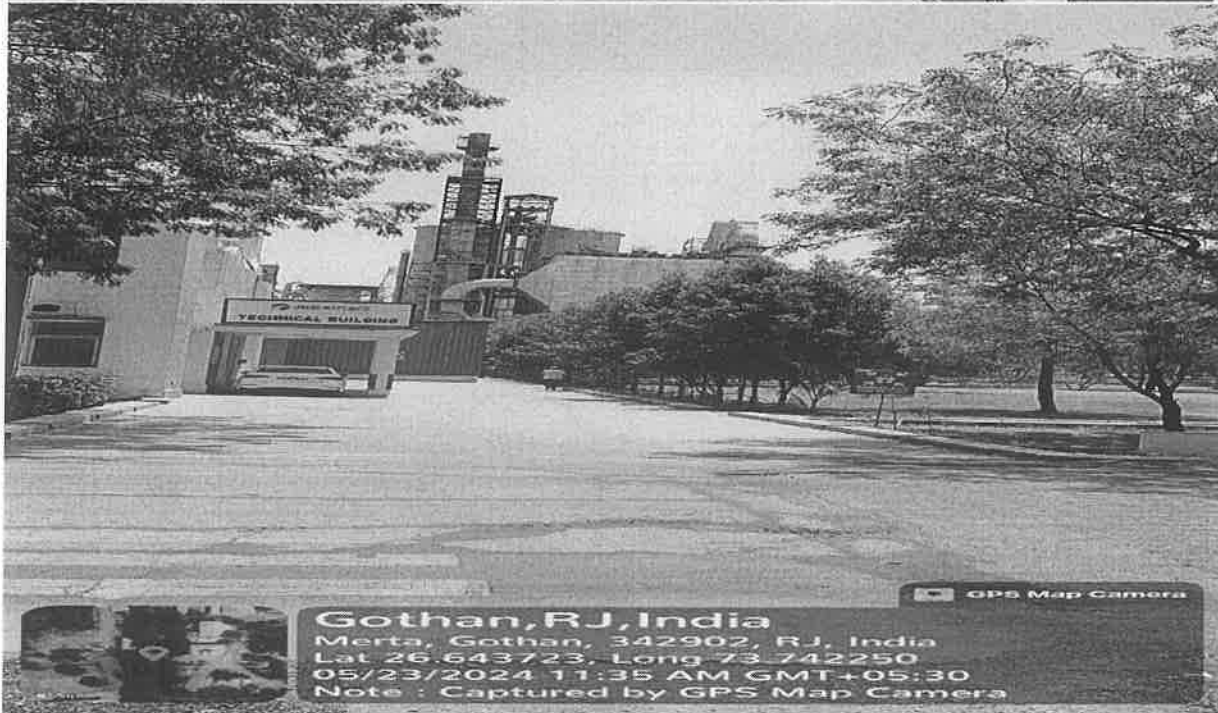

Plantation Photographs

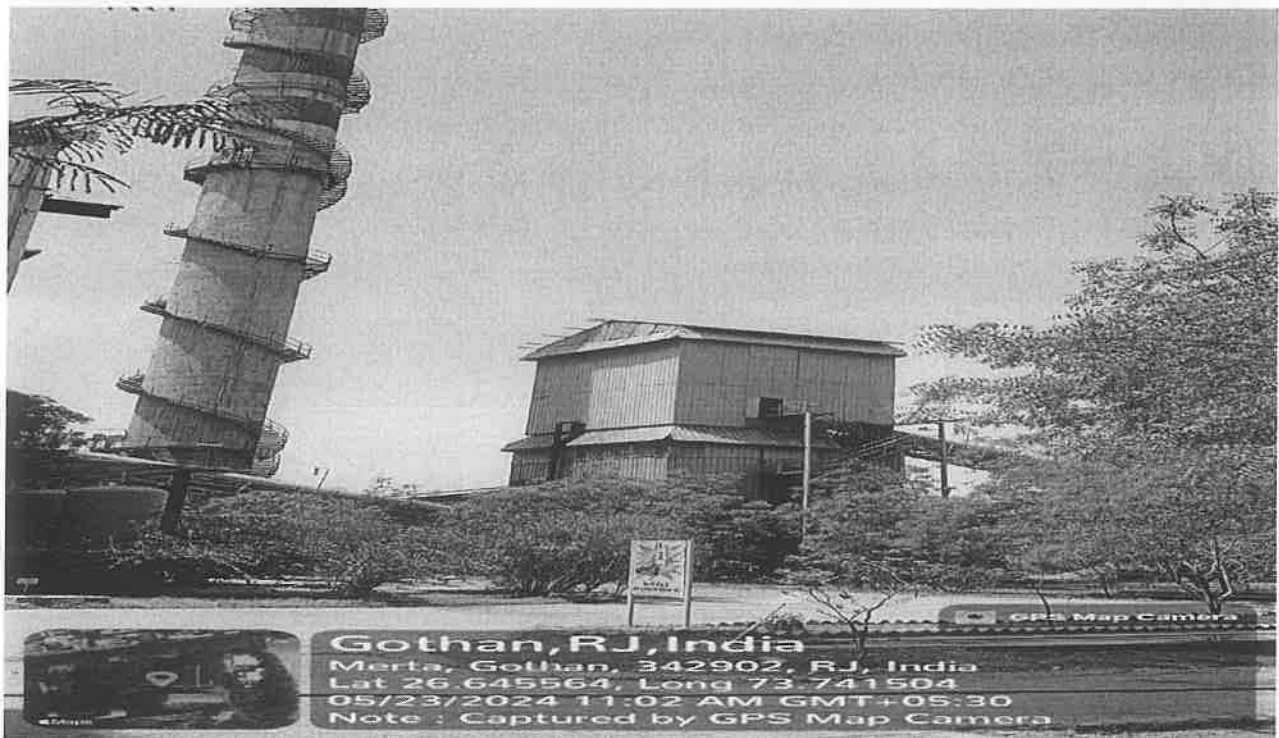
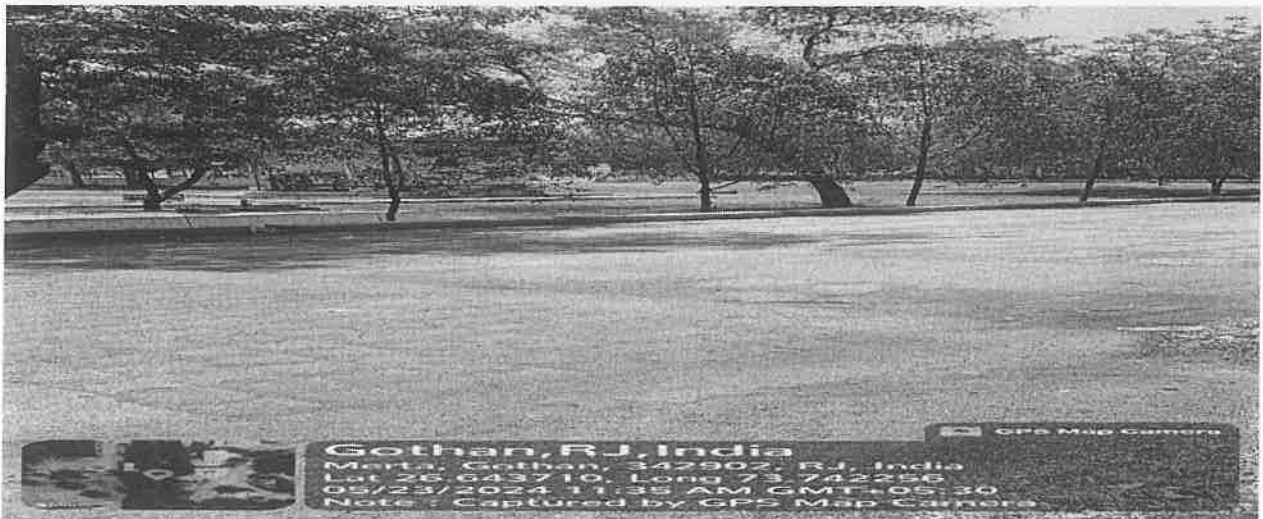
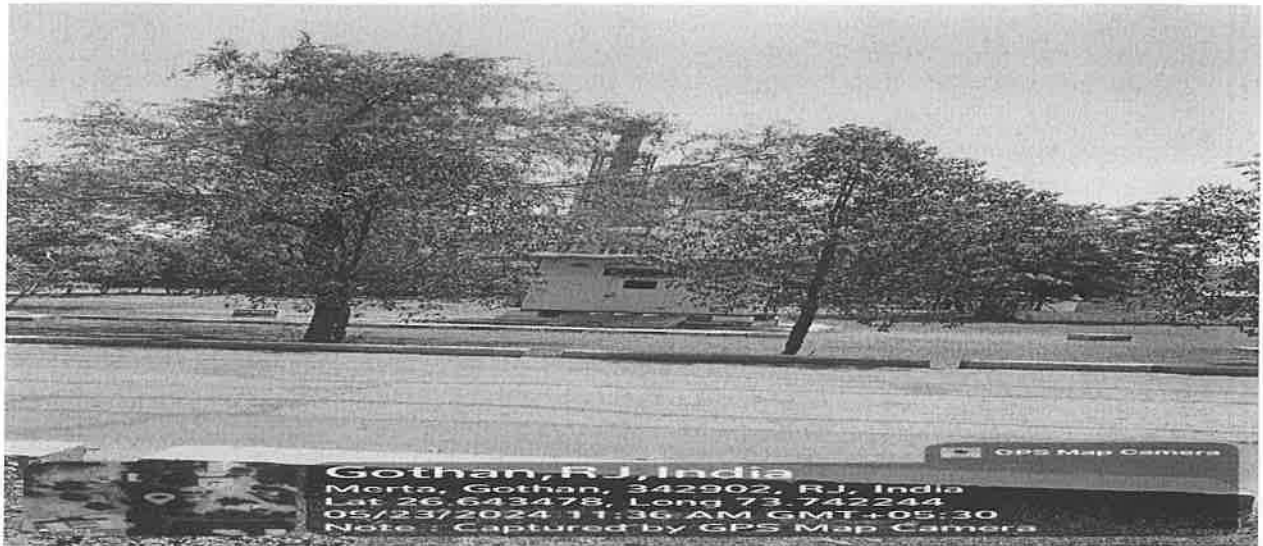

Water Consumption Details FY 2024-25
J K White Cement Works, Gotan (7.5 MW Power Plant)

S. No.	Month	Total water consumption in KL
1	April_24	0
2	May_24	0
3	June_24	0
4	July_24	0
5	Aug_24	0
6	Sep_24	0
Total		0

**Plant is under shutdown

Photographs of rain water harvesting at TPP



JK WHITE CEMENT WORKS, GOTAN FY 2024-25

Plant/Site	Employee Name	AUDIOMETRY	Blood Group	DISTANT VISION LEFT	DISTANT VISION RIGHT	ECG REPORT	HEIGHT	NEAR VISION LEFT	NEAR VISION RIGHT	SPIROMETRY	WEIGHT
Gotan-White	ABDUL KHAN	NORMAL	A+VE	6/6 GLAS	6/6 GLAS	NORMAL	165	N-6 GLS	N-6 GLS	NORMAL	79
Gotan-White	ABHISHEK JOSHI	ML BE	O+VE	6/6 C GLASS	6/6 C GLASS	NORMAL	182	N-6 C GLASS	N-6 C GLASS	MILD REST	82
Gotan-White	AJAY KUMAR	NORMAL	B+VE	6/6 C GLS	6/6 C GLS	NORMAL	181	N-6	N-6	NORMAL	78
Gotan-White	AJIT MISHRA	NORMAL	O+VE	6/6	6/6	NORMAL	182	N-6	N-6	NORMAL	105
Gotan-White	AKASH VERMA	NORMAL	B+VE	6/6	6/6	NORMAL	166	N-6	N-6	NORMAL	57
Gotan-White	AMAN JOSHI	NORMAL	B+VE	6/6	6/6	NORMAL	176	N/6	N/6	NORMAL	76
Gotan-White	AMIT KUMAR SHARMA	NORMAL	A+VE	6/6	6/6	NORMAL	168	N-6	N-6	NORMAL	75.9
Gotan-White	ANIL KUMAR	NORMAL	B+VE	6/6 C GLS	6/6 C GLS	NORMAL	174	N-6 C GLS	N-6 C GLS	MILD REST	81
Gotan-White	ANSHU SHARMA	NORMAL	O+VE	6/6	6/6	NORMAL	166	N-6	N-6	NORMAL	74
Gotan-White	APEKSHA	NORMAL	A+VE	6/6 C GLS	6/6 C GLS	NORMAL	162	N-6	N-6	NORMAL	61
Gotan-White	ARADHYA	NORMAL	O+VE	6/6 GLS	6/6 GLS	NORMAL	166	N-6 GLS	N-6 GLS	NORMAL	76
Gotan-White	ARJUN KUMAR	NORMAL	B+VE	6/6 C GLASS	6/6 C GLASS	NORMAL	165	N-6 C GLS	N-6 C GLS	NORMAL	85.8
Gotan-White	ARVIND	NORMAL	A+VE	6/6	6/6	NORMAL	181	N-6	N-6	NORMAL	75
Gotan-White	ASHUTOSH	NORMAL	B+VE	6/6 C GLASS	6/6 C GLASS	NORMAL	172	N-6 C GLASS	N-6 C GLASS	NORMAL	95
Gotan-White	ASHUTOSH	NORMAL	AB+VE	6/6	6/6	NORMAL	169	N-6	N-6	MILD REST	74
Gotan-White	ASLAM KHAN	NORMAL	AB+VE	6/6 CGLASS	6/6 CGLASS	NORMAL	177	N-6 CGLASS	N-6 CGLASS	MILD REST	79
Gotan-White	BABU KHAN	NORMAL	O+VE	6/6 C GLASS	6/6 C GLASS	NORMAL	171	N-6 C GLASS	N-6 C GLASS	NORMAL	86
Gotan-White	BABU LAL	NORMAL	A+VE	6/9	6/9	NORMAL	166	N-6	N-6	MILD REST	73
Gotan-White	BABU LAL	NORMAL	O+VE	6/6GLS	6/6 GLS	NORMAL	167	N-8 GLS	N-8 GLS	MILD REST	73
Gotan-White	BHAGWATI	ML BE	B+VE	6/6 GLS	6/6 GLS	NORMAL	168	N-6	N-6	NORMAL	61.8
Gotan-White	BHANWAR	NORMAL	O+VE	6/6	6/6	NORMAL	169	N-6 CGLASS	N-6 CGLASS	NORMAL	82
Gotan-White	BHARAT	NORMAL	B+VE	6/6 C GLS	6/6 C GLS	NORMAL	166	N-6 C GLS	N-6 C GLS	NORMAL	67.6
Gotan-White	BIRA SINGH	NORMAL	B+VE	6/9	6/9	NORMAL	169.5	N-6	N-6	NORMAL	84
Gotan-White	BIRMA RAM	NORMAL	B+VE	6/6	6/6	NORMAL	157	N-6	N-6	NORMAL	50
Gotan-White	BRIJ GOPAL	NORMAL	A+VE	6/6	6/6	NORMAL	179	N-6	N-6	MILD REST	128
Gotan-White	BRIJESH	NORMAL	O+VE	6/6	6/6	NORMAL	172	N-6	N-6	NORMAL	84
Gotan-White	CHAILA RAM	NORMAL	AB+VE	6/9	6/9	NORMAL	160	N-8 C GLS	N-8 C GLS	MILD REST	62
Gotan-White	DALPAT RAM	NORMAL	O+VE	6/6	6/6	NORMAL	165	N-6	N-6	MILD REST	79
Gotan-White	DANA RAM	NORMAL	B+VE	6/6 CGLASS	6/6 CGLASS	NORMAL	167	N-6 GLS	N-6 GLS	MILD REST	58
Gotan-White	DEEPAK	NORMAL	B+VE	6/6 C GLS	6/6 C GLS	NORMAL	178	N-6 C GLS	N-6 C GLS	NORMAL	91.8
Gotan-White	DEEPAK	NORMAL	B+VE	6/6	6/6	NORMAL	172.5	N-6	N-6	NORMAL	51
Gotan-White	DHANRAJ	NORMAL	O+VE	6/6	6/6	NORMAL	174	N-6	N-6	MILD REST	78
Gotan-White	DILIP KUMAR	NORMAL	B+VE	6/9 C GLASS	6/6 C GLASS	NORMAL	162	N-6	N-6	NORMAL	71.4
Gotan-White	DILIP SHARMA	NORMAL	AB+VE	6/6 C GLASS	6/6 C GLS	NORMAL	158	N-6 C GLS	N-6 C GLS	NORMAL	66
Gotan-White	FATEH SINGH	NORMAL	O+VE	6/6	6/6	NORMAL	177	N-6	N-6	MILD REST	73
Gotan-White	GAJENDRA	NORMAL	B+VE	6/6	6/6	NORMAL	166	N-6	N-6	NORMAL	63
Gotan-White	GAJENDRA	NORMAL	O+VE	6/6	6/6	NORMAL	173	N-6	N-6	MILD REST	81.5
Gotan-White	GIRJESH KUMAR	NORMAL	O-VE	6/6	6/6	NORMAL	175	N-6	N-6	NORMAL	86
Gotan-White	GODHA RAM	ML BE	A-VE	6/9 GLS	6/9 GLS	NORMAL	165	N-6 GLS	N-6 GLS	NORMAL	74.8
Gotan-White	GYANCHAND	NORMAL	A+VE	6/6	6/6	NORMAL	161	N-6	N-6	NORMAL	74
Gotan-White	HARENDRA	NORMAL	B+VE	6/6	6/6	NORMAL	165	N-6	N-6	NORMAL	104
Gotan-White	HEER SINGH	ML BE	A+VE	6/6 C GLS	6/6 C GLS	NORMAL	170	N-6 C GLS	N-6 C GLS	MILD REST	85
Gotan-White	IMRAN NAZIR	NORMAL	O + VE	6/6	6/6	NORMAL	162	N-6	N-6	NORMAL	67
Gotan-White	IPPILI	NORMAL	o+ve	6/6 C GLS	6/6 c gls	NORMAL	171	N-6 c gls	N-6 c gls	NORMAL	85
Gotan-White	JAGDISH CHAND	NORMAL	AB+VE	6/6 C GLASS	6/6 C GLASS	NORMAL	177	N-6 C GLS	N-6 C GLS	NORMAL	76
Gotan-White	JAGDISH	NORMAL	O+VE	6/6	6/6	NORMAL	175	N-6	N-6	NORMAL	79
Gotan-White	JAGDISH NAI	NORMAL	B+VE	6/6 GLS	6/6 GLS	NORMAL	171	N-6 GLS	N-6 GLS	NORMAL	74
Gotan-White	JAI PRAKASH	ML RE	A+VE	6/6	6/6	NORMAL	166	N-6	N-6	NORMAL	73
Gotan-White	JAY PRAKASH	NORMAL	A+VE	6/6	6/6	NORMAL	168	N-6	N-6	MILD REST	77.5
Gotan-White	JITENDRA	NORMAL	O+VE	6/6	6/6	NORMAL	163	N-6	N-6	MILD REST	64
Gotan-White	KAILASH	NORMAL	A+VE	6/6	6/6	NORMAL	173	N-6	N-6	NORMAL	101.8
Gotan-White	KAILASH NATH	NORMAL	B+VE	6/6	6/6	NORMAL	157	N-6	N-6	NORMAL	46
Gotan-White	KALYAN RAM	NORMAL	O+VE	6/6	6/6	NORMAL	162	N-6	N-6	NORMAL	60
Gotan-White	KAMAL KISHOR	NORMAL	A+VE	6/6 GLS	6/6 GLS	NORMAL	173	N-6 GLS	N-6GLS	NORMAL	71.5
Gotan-White	KAMAL	NORMAL	A-VE	6/6	6/6	NORMAL	181	N-6	N-6	MILD REST	79
Gotan-White	KANHIYA NATH	NORMAL	B+VE	6/6	6/6	NORMAL	172	N-6	N-6	NORMAL	96
Gotan-White	KESHA RAM	ML BE	O+VE	6/9	6/9	NORMAL	172	N-8 C GLS	N-8 C GLS	MILD REST	110
Gotan-White	KHALIL	NORMAL	AB+VE	6/9	6/9	NORMAL	170	N-8 C GLS	N-8 C GLS	NORMAL	63
Gotan-White	Kherajram	NORMAL	O+VE	6/6 GLS	6/6 GLS	NORMAL	178	N-6 GLS	N-6 GLS	NORMAL	89
Gotan-White	KHOWENDRA DAYARAM	NORMAL	B+VE	6/6 GLS	6/6 GLS	NORMAL	164	N-6GLS	N-6 GLS	NORMAL	59
Gotan-White	KISHAN LAL	ML BE	O+VE	6/6	6/6	NORMAL	174	N-6	N-6	NORMAL	63
Gotan-White	KRISHNA KANT	NORMAL	O+VE	6/6	6/6	NORMAL	173	N-6	N-6	NORMAL	87
Gotan-White	Kriti Sheen	NORMAL	AB+VE	6/6 GLS	6/6 GLS	NORMAL	163	N-6 GLS	N-6 GLS	NORMAL	67
Gotan-White	LAL SINGH	NORMAL	A+VE	6/6GLS	6/6GLS	NORMAL	174	N-6 c gls	N-6 c gls	NORMAL	71
Gotan-White	LALIT GARG	NORMAL	B+VE	6/6	6/6	NORMAL	176	N-6	N-6	NORMAL	79
Gotan-White	Laxman Singh	NORMAL	B+VE	6/6	6/6	NORMAL	180	N-6	N-6	NORMAL	82
Gotan-White	LAXMAN SINGH	NORMAL	B+VE	6/6 C GLS	6/9 C GLS	NORMAL	172	N-8C GLS	N-8C GLS	MILD REST	51.8
Gotan-White	LIVANJALI	NORMAL	B+VE	6/6 C GLS	6/6 C GLS	NORMAL	150	N-6	N-6	NORMAL	60
Gotan-White	LOKESH	NORMAL	A+VE	6/6 C GLASS	6/6 C GLASS	NORMAL	177	N-6 C GLASS	N-6 C GLASS	NORMAL	96
Gotan-White	LOKESH VERMA	NORMAL	A+VE	6/6 C GLASS	6/6 C GLASS	NORMAL	181	N-6 C GLASS	N-6 C GLASS	NORMAL	79
Gotan-White	MAHESH	NORMAL	O+VE	6/6	6/6	NORMAL	160	N-6	N-6	NORMAL	65

Gotan-White	MANGI LAL	NORMAL	AB+VE	6/9	6/9	NORMAL	158.5	N-6 CGLASS	N-6 CGLASS	NORMAL	57
Gotan-White	MANISH	NORMAL	AB +VE	6/6	6/6	NORMAL	171	N-6	N-6	NORMAL	76
Gotan-White	MANISH	NORMAL	B+VE	6/6	6/6	NORMAL	164	N-6	N-6	NORMAL	79
Gotan-White	MANMOHAN	NORMAL	A+VE	6/6	6/6	NORMAL	167	N-6	N-6	MILD REST	64.8
Gotan-White	MANOJ KUMAR	NORMAL	A+VE	6/6	6/6	NORMAL	167	N-6 GLS	N-6 GLS	MILD REST	73
Gotan-White	MATA DEEN	NORMAL	A+VE	6/6 C GLS	6/6 C GLS	NORMAL	153	N-6 C GLS	N-6 C GLS	NORMAL	66.5
Gotan-White	MOINUDDIN	NORMAL	O+VE	6/6	6/6	NORMAL	175	N-6	N-6	MILD REST	82
Gotan-White	MUKESH	NORMAL	B+VE	6/6	6/6	NORMAL	174	N-6	N-6	MILD REST	90
Gotan-White	MUKESH	NORMAL	B+VE	6/6	6/6	NORMAL	179	N-6	N-6	NORMAL	52
Gotan-White	MUKESH	NORMAL	B+VE	6/6	6/6	NORMAL	166	N-6 C GLS	N-6 C GLS	MILD REST	75
Gotan-White	NAINA RAM	NORMAL	B+VE	6/6	6/6	NORMAL	173	N-6 CGLASS	N-6 CGLASS	NORMAL	68
Gotan-White	NARAYAN LAL	ML BE	O+VE	6/6 CGLASS	6/6 CGLASS	NORMAL	171	N-6	N-6	MILD REST	53
Gotan-White	NARENDRA	NORMAL	B-VE	6/6	6/6	NORMAL	171	N-6	N-6	MILD REST	53
Gotan-White	NITESH GUPTA	NORMAL	O+VE	6/6 GLS	6/6 GLS	NORMAL	161	N-6 GLS	N-6 GLS	NORMAL	65.5
Gotan-White	OM PRAKASH	ML BE	A+ve	6/6	6/6	NORMAL	164	N-6	N-6	MILD REST	64
Gotan-White	OM PRAKASH	NORMAL	O+VE	6/9 CGLASS	6/9 CGLASS	NORMAL	172	N-6 CGLASS	N-6 CGLASS	NORMAL	69.3
Gotan-White	OM PRAKASH	ML BE	O+VE	6/6 C GLS	6/6 C GLS	NORMAL	173	N-6	N-6	MILD REST	74
Gotan-White	ONKAR LAL	NORMAL	B+VE	6/6	6/6	NORMAL	174	N-6	N-6	NORMAL	85
Gotan-White	ONKAR NATH	NORMAL	A+VE	6/6 C GLASS	6/6 C GLASS	NORMAL	168	N-6 C GLASS	N-6 C GLASS	MILD REST	79
Gotan-White	PARMANAND	NORMAL	B+VE	6/6	6/6	NORMAL	178	N-6	N-6	NORMAL	97
Gotan-White	POKAR RAM	ML LE	O+VE	6/9 GLS	6/9 GLS	NORMAL	161	N-6 GLS	N-6 GLS	MILD REST	77
Gotan-White	PRAHLAD RAM	NORMAL	B+VE	6/6 C GLASS	6/6 C GLASS	NORMAL	178	N-6 C GLASS	N-6 C GLASS	NORMAL	86
Gotan-White	PRAKASH	NORMAL	O+VE	6/6	6/6	NORMAL	173	N-6	N-6	NORMAL	72
Gotan-White	PRATHVI RAJ	NORMAL	A+VE	6/6 C GLS	6/6 C GLS	NORMAL	172	N-6 C GLS	N-6 C GLS	MILD REST	68.16
Gotan-White	Praveen Pancholi	NORMAL	B+VE	6/6	6/6	NORMAL	161	N-6	N-6	NORMAL	69.8
Gotan-White	Praveen Singh	NORMAL	A+VE	6/6	6/6	NORMAL	172	N-6	N-6	NORMAL	84
Gotan-White	PRAVEEN SINGH	NORMAL	A-VE	6/6	6/6	NORMAL	159	N-8 C GLS	N-8 C GLS	MILD REST	73
Gotan-White	PREM SINGH	NORMAL	A +VE	6/6 CGLASS	6/6 CGLASS	NORMAL	167	N-6 CGLASS	N-6 CGLASS	MILD REST	73.6
Gotan-White	PUSHPENDRA	NORMAL	O+VE	6/6	6/6	NORMAL	170	N-6	N-6	NORMAL	83
Gotan-White	RAHUL	NORMAL	O+VE	6/6	6/6	NORMAL	166	N-6	N-6	MILD REST	55
Gotan-White	Rahul Bhardwaj	NORMAL	AB+VE	6/6	6/6	NORMAL	170	N-6	N-6	NORMAL	81
Gotan-White	RAHUL JAIN	NORMAL	B+VE	6/6	6/6	NORMAL	184	N-6	N-6	NORMAL	98
Gotan-White	RAHUL SAIN	NORMAL	A+VE	6/6	6/6	NORMAL	178	N-6	N-6	NORMAL	104
Gotan-White	RAM CHANDRA	NORMAL	O+VE	6/9 CGLASS	6/9 C GLASS	NORMAL	175	N-8 GLS	N-8 GLS	NORMAL	95
Gotan-White	RAM DEV VYAS	NORMAL	B+VE	6/9 C GLS	6/9 C GLS	NORMAL	165	N-8 C GLS	N-8 C GLS	NORMAL	68
Gotan-White	RAM LAL	NORMAL	O+VE	6/6	6/6	NORMAL	167	N-6C GLASS	N-6C GLASS	NORMAL	73
Gotan-White	RAM NIWAS	NORMAL	B+VE	6/6	6/6	NORMAL	176	N-6 C GLASS	N-6 C GLASS	NORMAL	78
Gotan-White	RAM NIWAS	NORMAL	B+VE	6/6 CGLASS	6/6 CGLASS	NORMAL	177	N-6 GLS	N-6 GLS	NORMAL	86
Gotan-White	RAM NIWAS	NORMAL	B+VE	6/6 CGLASS	6/6 CGLASS	NORMAL	169	N-6 C GLS	N-6 C GLS	MILD REST	76
Gotan-White	RAM PRAKASH	NORMAL	A+VE	6/6	6/6	NORMAL	169	N-6	N-6	MILD REST	80
Gotan-White	SAHI RAM	ML BE	A -VE	6/9	6/9	NORMAL	174	N-6 GLS	N-6 GLS	NORMAL	90
Gotan-White	SARDARA RAM	NORMAL	B+VE	6/6	6/6	NORMAL	174	N-6 GLS	N-6 GLS	NORMAL	90
Gotan-White	SAROJ KUMAR	NORMAL	A+VE	6/6 CGLASS	6/6 CGLASS	NORMAL	164	N-6 CGLASS	N-6 CGLASS	NORMAL	73
Gotan-White	SATYANDRA	NORMAL	B-VE	6/6	6/6	NORMAL	183	N-6	N-6	NORMAL	74
Gotan-White	SATYENDRA	NORMAL	B+VE	6/6	6/6	NORMAL	169	N-6	N-6	NORMAL	61
Gotan-White	SATYENDRA	NORMAL	O+VE	6/6 CGLASS	6/6 CGLASS	NORMAL	171	N-6 CGLASS	N-6 CGLASS	MILD REST	73
Gotan-White	SHAFIK ALI	NORMAL	B+VE	6/6 CGLASS	6/6 CGLASS	NORMAL	165	N-6 CGLASS	N-6 CGLASS	NORMAL	81
Gotan-White	SHAIENDRA	NORMAL	O+VE	6/6 CGLASS	6/6 CGLASS	NORMAL	162.5	N-6 CGLASS	N-6 CGLASS	NORMAL	68.6
Gotan-White	SHALINI SABU	NORMAL	O+VE	6/6 C GLASS	6/9 C GLASS	NORMAL	151	N-6 C GLASS	N-8 C GLASS	MILD REST	63
Gotan-White	SHELENDRA	NORMAL	B+VE	6/6	6/6	NORMAL	169	N-8 C GLS	N-8 C GLS	NORMAL	72
Gotan-White	SHISHPAL	NORMAL	A+VE	6/6	6/6	NORMAL	167	N-6	N-6	NORMAL	77
Gotan-White	SHRI RAM	NORMAL	A+VE	6/6 CGLASS	6/6 CGLASS	NORMAL	174	N-6 CGLASS	N-6 CGLASS	NORMAL	78.9
Gotan-White	SHYAM LAL	NORMAL	A+VE	6/6 C GLS	6/6 C GLS	NORMAL	174	N-6 C GLS	N-6 C GLS	NORMAL	100
Gotan-White	SRI RAM	NORMAL	A + VE	6/6	6/6	NORMAL	165	N-6 C GLASS	N-6 C GLASS	NORMAL	73
Gotan-White	SURENDER	NORMAL	A+VE	6/6 GLS	6/6 GLS	NORMAL	162	N-6 GLS	N-6 GLS	NORMAL	63
Gotan-White	SUSHIL KUMAR	NORMAL	B+VE	6/6	6/9	NORMAL	170	N-6	N-6	NORMAL	76
Gotan-White	TEJ PAL SINGH	NORMAL	B+VE	6/6 C GLS	6/9 C GLS	NORMAL	180	N-6 C GLS	N-6 C GLS	MILD REST	79
Gotan-White	VIJAY	NORMAL	B+VE	6/6 C GLS	6/6 C GLS	NORMAL	171	N-6 C GLS	N-6 C GLS	NORMAL	82
Gotan-White	VIJAY SONI	NORMAL	B+VE	6/6	6/6	NORMAL	162	N-6	N-6	MILD REST	64.7
Gotan-White	VIKAS KUMAR	NORMAL	O+VE	6/6	6/6	NORMAL	174	N-6	N-6	NORMAL	74
Gotan-White	VIRENDRA	NORMAL	B+VE	6/9 GLS	6/9 GLS	NORMAL	172	N-6 GLS	N-6 GLS	NORMAL	77
Gotan-White	VIRENDRA	NORMAL	A+VE	6/6 C GLS	6/6 C GLS	NORMAL	173	N-6 C GLS	N-6 C GLS	MILD REST	65.8
Gotan-White	YOGENDRA	NORMAL	B+VE	6/6 C GLASS	6/6 C GLASS	NORMAL	155	N-6 C GLASS	N-6 C GLASS	NORMAL	102
Gotan-White	YOGESH NAGAR	NORMAL	B+VE	6/6	6/6	NORMAL	172	N-6	N-6	MILD REST	84